



Winchester City Council

DRAFT PORTFOLIO HOLDER DECISION NOTICE

PROPOSED INDIVIDUAL DECISION BY THE PORTFOLIO HOLDER FOR HIGH QUALITY ENVIRONMENT

TOPIC – TRAFFIC REGULATION ORDER – ANDOVER ROAD, BRUNEL CLOSE, MILL PLACE, NEW ROAD AND OVERTON ROAD, MICHELDEVER STATION

PROCEDURAL INFORMATION

The Access to Information Procedure Rules – Part 4, Section 22 of the Council's Constitution provides for a decision to be made by an individual member of Cabinet.

In accordance with the Procedure Rules, the Corporate Director (Governance), the Chief Executive and the Head of Finance are consulted together with Chairman and Vice Chairman of the Principal Scrutiny Committee and all Members of the relevant Scrutiny Panel (individual Ward Members are consulted separately where appropriate). In addition, all Members are notified.

Five or more of these consulted Members can require that the matter be referred to Cabinet for determination.

If you wish to make representation on this proposed Decision please contact the relevant Portfolio Holder and the following Committee Administrator by 5.00pm on Friday 18 February 2011.

Contact Officers:

Case Officer:

Neville Crisp. Traffic Engineer. Tel: 01962 848484. Email: ncrisp@winchester.gov.uk

Committee Administrator:

Nancy Graham. Senior Democratic Services Officer. Tel: 01962 848235.

Email: ngraham@winchester.gov.uk

SUMMARY

- It is proposed to introduce 'No waiting at any time' restrictions in Andover Road, Brunel Close, Mill Place, New Road and Overton Road, Micheldever Station partly in conjunction with the construction of a new footway. The new restrictions are considered necessary to ensure the footway is kept clear of vehicles and to control parking and waiting to improve access and visibility for the safety for residents and all road users.

- The proposal is in keeping with the Corporate Priorities in its attempt to improve traffic management, road safety and the environment.
- 2 letters/emails were received relating to the proposal. One requesting further information/clarification and one commenting that restrictions should perhaps go further than advertised. (Appendix 1)
- No formal objections were received to the proposal.
- The cost of the proposal is being funded directly by Hampshire County Council. There are no additional enforcement costs.
- Copy of the plan showing the location of the proposals is attached. (Appendix 2)
- Copy of proposed schedule and a statement of reasons are attached. (Appendix 3)

PROPOSED DECISION

- It is recommended to introduce 'No waiting at any time' restrictions in Andover Road, Brunel Close, Mill Place, New Road and Overton Road as advertised and the Head of Legal Services be authorised to make the necessary order.

REASON FOR THE PROPOSED DECISION AND OTHER ALTERNATIVE OPTIONS CONSIDERED AND REJECTED

See Summary.

RESOURCE IMPLICATIONS:

No implications.

CONSULTATION UNDERTAKEN ON THE PROPOSED DECISION

- The proposed restrictions were prepared and submitted to the local Ward Members, Portfolio Holder, County Councillor and Police for their approval to proceed formally.
- All properties in the immediate vicinity of the proposed restrictions and the Parish Council, were subsequently contacted by letter and notified about the extent and type of restrictions being formally pursued.
- Proposal notices were placed in the Mid Hants Observer and posted on street accordingly. (Appendix 4)

**FURTHER ALTERNATIVE OPTIONS CONSIDERED AND REJECTED
FOLLOWING PUBLICATION OF THE DRAFT PORTFOLIO HOLDER DECISION
NOTICE**

See Summary.

**DECLARATION OF INTERESTS BY THE DECISION MAKER OR A MEMBER OR
OFFICER CONSULTED**

None.

DISPENSATION GRANTED BY THE STANDARDS COMMITTEE

Not applicable.

Approved by: (signature)

Date of Decision

Councillor Eleanor Bell – Portfolio Holder for High Quality Environment

Neville Crisp

From: David Davies
Sent: 20 December 2010 12:45
To: Neville Crisp
Subject: RE: waiting restrictions

Dear Neville,

I had been forwarded the attached letter and drawing ref parking restrictions at Mill Place/Overton Rd.

While it is appreciated that something is being done to prevent dangerous parking at this junction, I noted from the drawing that the restriction to the South of the Mill Place/Overton Road junction is only right on the corner. Would it be possible to extend the yellow lines further south of the junction to allow vehicles exiting Mill Place to have a clear view in both directions?

With the proposed restriction there will still be cars parked close to the junction making it extremely hazardous in trying to exit Mill Place

Regards Dave Davies

DEVELOPMENT
04 JAN 2011
19506 NC
ACCESS & INFRASTRUCTURE

Thomas
Eggar

Thomas Eggar LLP
Newbury House 20 King's Road West
Newbury Berkshire RG14 5XR

Telephone +44 (0)1635 571 000
Facsimile +44 (0)1635 523 444
DX no. 30801 Newbury

Winchester City Council
Access & Infrastructure
City Offices
Colebrook Street
WINCHESTER
SO23 9LJ

OFFICE SUPPORT
30 DEC 2010

Our ref: ARJ/NE/145063615
Your ref: 810402-221

17 December 2010

Dear Sirs

Proposed waiting restrictions Micheldever Station

We act for Micheldever Tyre Services Limited.

We refer to your letter dated 8 December, received by our client on 13 December, setting out details of the proposed waiting restrictions around Micheldever Station.

Our client is concerned to learn of the intended restrictions specifically those south of the junction of Micheldever Station with Brunel Close to the point just north of Railway Cottage, as set out on the plan enclosed with your letter.

As is evident from that plan, these particular restrictions about the "depot" from which our client carries on its business. Our client's concern is that the proposed restrictions along this part of the highway will have serious and considerable impact on its business. It is often the case that, at busy times, (such as weekends) the number of customers wishing to purchase fitted tyres leads to small queues of traffic which result in short delays in customers entering our client's premises. Such delays are usually no more than 5-10 minutes.

Having considered the relevant legislation, it is our view that static cars in queuing traffic do not come within the ambit of "waiting" for the purposes of the intended restrictions but if the Council has a different view we would welcome your comments and any relevant authorities upon which you rely.

Notwithstanding, our client believes the intended restrictions are unreasonable and unfair and is unable to understand why the same are required on that particular part of the highway. Despite the suggestion in your letter that the proposals are "minimal" there does not appear to be any justification for the extent of the restrictions suggested and we would be grateful if you can provide an explanation for the same.

NE: 7583315_1

We look forward to hearing from you accordingly.

Yours faithfully

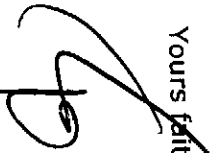

Thomas Eggar LLP

Email: andrew.jackson@thomaseggar.com

Direct Dial: 01635 571077

Direct Fax: 01635 571123



NO WAITING AT ANY TIME
 (DOUBLE YELLOW LINES)

Rev.	Description	Date	Drawn
A	Restrictions extended in Overton Road.	22/11/01	NVC



Winchester
 City Council

DEVELOPMENT SERVICES

ENGINEERING

City Offices
 Colebrook Street
 Winchester,
 SO23 9LJ.

© Winchester City Council

Project:

TRAFFIC ORDERS
 PERMANENT

Title:

PROPOSED WAITING RESTRICTIONS
 MICHELDEVER STATION

Scale: NTS Date: OCT 2010

Drawn: NVC Checked:

DRG. No. 810402/221/001 A

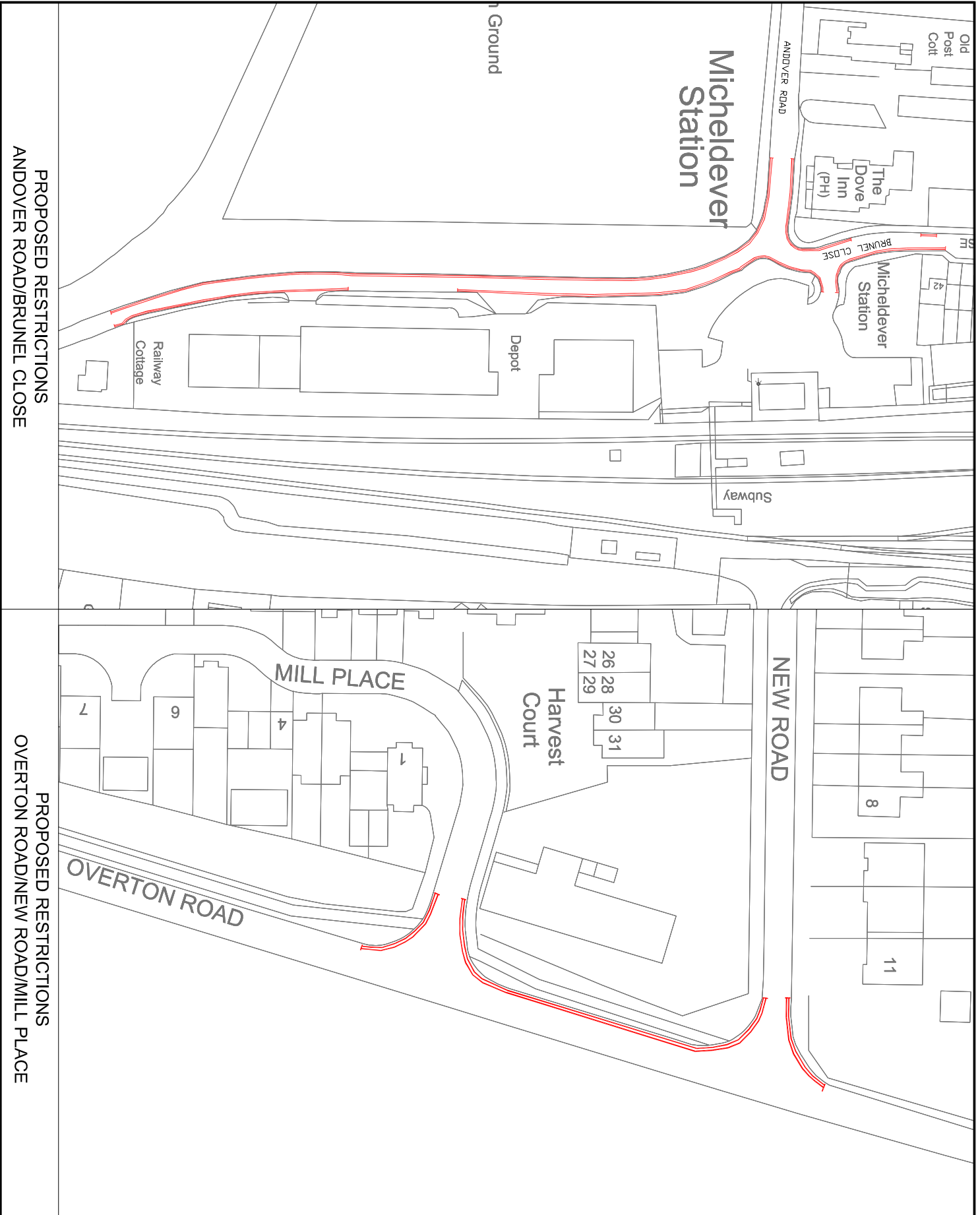

PROPOSED RESTRICTIONS
 ANDOVER ROAD/BRUNEL CLOSE

PROPOSED RESTRICTIONS
 OVERTON ROAD/NEW ROAD/MILL PLACE

PROPOSED ORDER:-WINCHESTER CITY COUNCILROAD TRAFFIC REGULATION ACT 1984THE WINCHESTER CITY COUNCIL (VARIOUS ROADS, MICHELDEVER STATION)
(PARKING PLACES AND RESTRICTION OF WAITING) ORDER 2010**STATEMENT OF REASONS:-**

The scheme is being proposed on traffic management and road safety grounds to prevent obstructive parking of vehicles which hinder access, visibility and safety.

PROPOSED SCHEDULE:-

<u>NO WAITING AT ANY TIME</u>		
NAME OF ROAD	SIDE	DESCRIPTION
ANDOVER ROAD	NORTH-EAST	FROM A POINT 23.5 METRES WEST OF ITS JUNCTION WITH BRUNEL CLOSE TO A POINT 98.7 METRES SOUTH OF THAT JUNCTION.
ANDOVER ROAD	EAST	FROM A POINT 122.0 METRES SOUTH OF ITS JUNCTION WITH BRUNEL CLOSE TO A POINT 198.0 METRES SOUTH OF THAT JUNCTION.
ANDOVER ROAD	SOUTH-WEST	FROM A POINT 23.5 METRES WEST OF ITS JUNCTION WITH BRUNEL CLOSE TO A POINT 198.0 METRES SOUTH OF THAT JUNCTION.
BRUNEL CLOSE	EAST	FROM ITS JUNCTION WITH ANDOVER ROAD TO A POINT 54.8 METRES NORTH OF THAT JUNCTION.
BRUNEL CLOSE	WEST	FROM ITS JUNCTION WITH ANDOVER ROAD TO A POINT 21.3 METRES NORTH OF THAT JUNCTION.
BRUNEL CLOSE	WEST	FROM A POINT 43.6 METRES NORTH OF ITS JUNCTION WITH ANDOVER ROAD TO A POINT 50.3 METRES NORTH OF THAT JUNCTION.
MILL PLACE	BOTH	FROM ITS JUNCTION WITH OVERTON ROAD TO A POINT 12.7 METRES WEST OF THAT JUNCTION.
NEW ROAD	BOTH	FROM ITS JUNCTION WITH OVERTON ROAD TO A POINT 13.5 METRES WEST OF THAT JUNCTION.
OVERTON ROAD	BOTH	FROM A POINT 8.5 METRES NORTH OF ITS JUNCTION WITH NEW ROAD TO A POINT 12.5 METRES SOUTH OF MILL PLACE.

**Notice of Proposals of making of Various Road Traffic Regulation Orders
Affecting the District of Winchester City Council**

Winchester City Council as agents for Hampshire County Council proposes making the undermentioned road traffic regulation orders:-

7. The Hampshire (Various Roads, Wonston and Micheldever) (Parking Places and Restriction of Waiting) Order 2010.

The effect of this order will be to introduce waiting restrictions in Micheldever, Details are as follows:-

<u>NO WAITING AT ANY TIME</u>		
<i>NAME OF ROAD</i>	<i>SIDE</i>	<i>DESCRIPTION</i>
ANDOVER ROAD	NORTH-EAST	FROM A POINT 23.5 METRES WEST OF ITS JUNCTION WITH BRUNEL CLOSE TO A POINT 98.7 METRES SOUTH OF THAT JUNCTION.
ANDOVER ROAD	EAST	FROM A POINT 122.0 METRES SOUTH OF ITS JUNCTION WITH BRUNEL CLOSE TO A POINT 198.0 METRES SOUTH OF THAT JUNCTION.
ANDOVER ROAD	SOUTH-WEST	FROM A POINT 23.5 METRES WEST OF ITS JUNCTION WITH BRUNEL CLOSE TO A POINT 198.0 METRES SOUTH OF THAT JUNCTION.
BRUNEL CLOSE	EAST	FROM ITS JUNCTION WITH ANDOVER ROAD TO A POINT 54.8 METRES NORTH OF THAT JUNCTION.
BRUNEL CLOSE	WEST	FROM ITS JUNCTION WITH ANDOVER ROAD TO A POINT 21.3 METRES NORTH OF THAT JUNCTION.
BRUNEL CLOSE	WEST	FROM A POINT 43.6 METRES NORTH OF ITS JUNCTION WITH ANDOVER ROAD TO A POINT 50.3 METRES NORTH OF THAT JUNCTION.
MILL PLACE	BOTH	FROM ITS JUNCTION WITH OVERTON ROAD TO A POINT 12.7 METRES WEST OF THAT JUNCTION.
NEW ROAD	BOTH	FROM ITS JUNCTION WITH OVERTON ROAD TO A POINT 13.5 METRES WEST OF THAT JUNCTION.

OVERTON ROAD	BOTH	FROM A POINT 8.5 METRES NORTH OF ITS JUNCTION WITH NEW ROAD TO A POINT 12.5 METRES SOUTH OF MILL PLACE.
--------------	------	---

FURTHER DETAILS: A copy of this notice, the proposed orders, and maps showing the location and effect of the proposals, a statement of reasons and the order to be varied may be inspected during usual office hours at the following place:-

- (i) City Offices, Colebrook Street, Winchester.

OBJECTIONS: All objections and other representations in respect of this proposal must be sent in writing to the undersigned by 7th January 2011. All objections must state the grounds on which they are made.

Dated this 1st day of December 2010

H. N. Bone, Head of Legal Services,
Winchester City Council, City Offices, Colebrook Street, Winchester, Hampshire.