



PORTFOLIO HOLDER DECISION NOTICE

INDIVIDUAL DECISION BY THE PORTFOLIO HOLDER FOR BUILT ENVIRONMENT

TOPIC –20 MILES PER HOUR SPEED LIMIT, HIGHCLIFFE

PROCEDURAL INFORMATION

The Access to Information Procedure Rules – Part 4, Section 22 of the Council's Constitution provides for a decision to be made by an individual member of Cabinet.

In accordance with the Procedure Rules, the Chief Operating Officer, the Chief Executive and the Chief Finance Officer are consulted together with Chairman and Vice Chairman of The Overview and Scrutiny Committee and any other relevant overview and scrutiny committee. In addition, all Members are notified.

If five or more Members from those informed so request, the Leader may require the matter to be referred to Cabinet for determination.

Contact Officers:

Case Officer: Sara Davies. Traffic & Transport Engineer Tel: 01962 848241. Email: sdavies@winchester.gov.uk

Democratic Services Officer: Nancy Graham. Senior Democratic Services Officer. Tel: 01962 848235. Email: ngraham@winchester.gov.uk

SUMMARY

- New regulations from the Department for Transport have meant that it is now easier to implement 20mph speed limits in residential areas. Hampshire County Council had chosen 10 areas around the county to be pilot schemes for these new speed limits.
- In addition to the pilot schemes, Hampshire County Council's Executive Member for Environment & Transport on 23 July 2013 agreed to allow the City Council under its Traffic Management Agency arrangements to progress an area wide 20mph speed limit for Highcliffe.
- The 20mph speed limit proposal for Highcliffe was advertised for public comment in October and November 2013.
- The proposal is in keeping with the Sustainable Community Strategy. The proposal contributes to the High Quality Environment outcome and those

objectives by reducing speeds to encourage the use of walking and cycling as transport modes in Highcliffe and improving the 'place' that is enjoyed by the residents.

- No letters of objections were received to the proposals.
- One supporting letter was received. This letter asked for the locations of repeater signs to be carefully considered. Under the new regulations set by the Department for Transport, repeater signs will not be used and the speed limit will be reinforced by roundels/road markings. Terminal signage at the extent of the speed limit areas will still need to be erected.
- The cost of the proposal will be mainly funded through the Winchester Town Account, with additional funding from the Traffic Management Agency Agreement with Hampshire County Council.
- A copy of the plan showing the area covered by the proposed order is attached (Appendix 1).
- A copy of the statement of reasons and list of roads to be covered by the proposed is attached (Appendix 2).
- A copy of the proposal notice is attached (Appendix 3).
- A copy of the advertised order is attached (Appendix 4).

DECISION

That the 20 miles per hour speed limit be introduced in Highcliffe (covering those roads as detailed in advertised order attached as Appendix 4 to the Decision Notice) and the Head of Legal and Democratic Services be authorised to make the necessary order.

REASON FOR THE DECISION AND OTHER ALTERNATIVE OPTIONS CONSIDERED AND REJECTED

No objections were received for the speed limit order. The proposals did not, therefore, need to be decided by committee. The Highcliffe proposal has previously been discussed at Cabinet (Traffic & Parking Committee) on 25th February 2013. <http://www.winchester.gov.uk/meetings/details/1160> and at the Winchester Town Forum on 11th September 2013 (WTF190) <http://www.winchester.gov.uk/meetings/details/1231>

The reasons for making the order, as set out in the Statement of Reasons in Appendix 2 to this Decision Notice, remain.

RESOURCE IMPLICATIONS:

The advertising and implementation of these traffic regulation orders, forecast to cost £2,000, will be covered by the Town Account as part of its approved 2013/2014 budget for 20mph schemes of £4,156.

The total cost estimate for the scheme is £4,500. The remaining costs of £2,500, needed for 20mph road markings, will be funded by the Traffic Management Agency Agreement with Hampshire County Council.

CONSULTATION UNDERTAKEN ON THE DECISION

- An informal survey of the residents of Highcliffe on draft proposals for an area- wide 20mph speed limit took place in December 2012/January 2013, and these results show that the majority of residents who responded are in support of a lower speed limit.
- The scheme was then submitted to the local Ward Members, Portfolio Holder, County Councillor and Police for their approval to proceed formally.
- Proposal notices were placed in the Mid Hants Observer and posted on street accordingly in October/November 2013. (Appendix 3)

FURTHER ALTERNATIVE OPTIONS CONSIDERED AND REJECTED FOLLOWING PUBLICATION OF THE DRAFT PORTFOLIO HOLDER DECISION NOTICE

N/A

DECLARATION OF INTERESTS BY THE DECISION MAKER OR A MEMBER OR OFFICER CONSULTED

N/A

DISPENSATION GRANTED BY THE STANDARDS COMMITTEE

N/A

Approved by: (signature)

Date of Decision: 05.02.14

Councillor Weston – Portfolio Holder for Built Environment

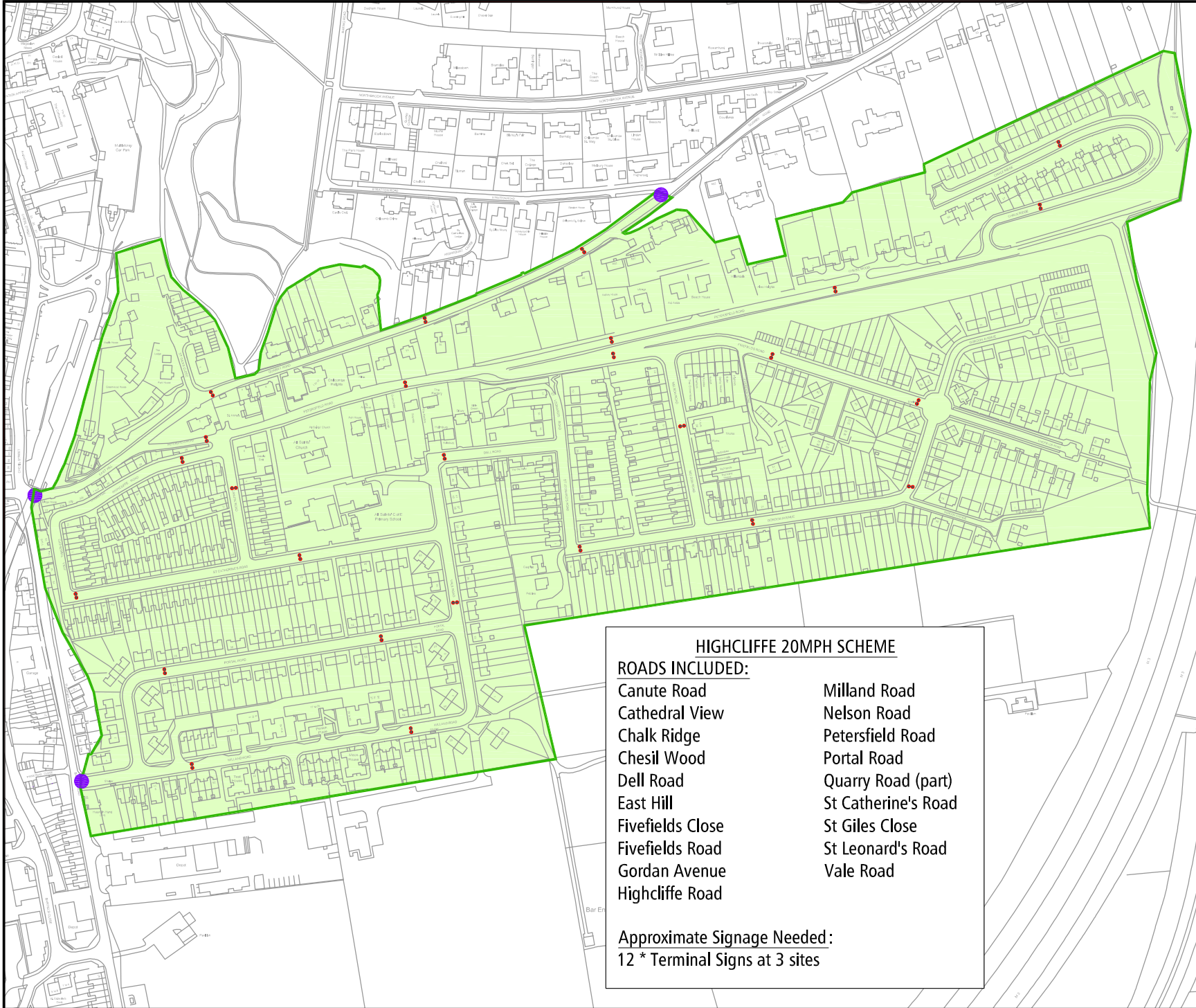

HIGHCLIFFE 20MPH SCHEME

ROADS INCLUDED:

Canute Road	Milland Road
Cathedral View	Nelson Road
Chalk Ridge	Petersfield Road
Chesil Wood	Portal Road
Dell Road	Quarry Road (part)
East Hill	St Catherine's Road
Fivefields Close	St Giles Close
Fivefields Road	St Leonard's Road
Gordan Avenue	Vale Road
Highcliffe Road	

Approximate Signage Needed:
 12 * Terminal Signs at 3 sites

© Crown copyright and database rights 2012
 Winchester City Council license 100019531

 APPROXIMATE LOCATIONS OF ROUNDELS

 TERMINAL SIGNS 600MM

Rev.	Description	Date	Drawn
------	-------------	------	-------



OPERATIONS GROUP
 ACCESS & INFRASTRUCTURE
 City Offices
 Colebrook Street
 Winchester,
 SO23 9LJ.



© Winchester City Council

Project: TRAFFIC MANAGEMENT
 TRAFFIC ORDERS

Title: 20 MPH
 HIGHCLIFFE
 WINCHESTER

Scale: NTS	Date: 26/11/2012
Drawn: SK	Checked:
DRG. No. 810402/248/003	Status:

NEW ORDER:

WINCHESTER CITY COUNCIL

ROAD TRAFFIC REGULATION ACT, 1984

THE HAMPSHIRE (VARIOUS ROADS, HIGHCLIFFE, WINCHESTER)
(20 MILES PER HOUR SPEED LIMIT)
ORDER 2013

STATEMENT OF REASONS:-

The proposal will see a reduction in the speed limit in all the roads stated below, encouraging a positive impact on the use of walking and cycling as transport modes and the reduction in severity of any personal injury accidents that may occur.

Road to be subject to 20mph Speed limit

Roads in the District of Winchester
20 mph Speed Limit

Highcliffe

- (i) Canute Road, for its entirety
- (ii) Cathedral View, for its entirety
- (iii) Chalk Ridge, for its entirety
- (iv) Chesil Wood, for its entirety
- (v) Dell Road, for its entirety
- (vi) East Hill, for its entirety
- (vii) Fivefields Close, for its entirety
- (viii) Fivefields Road, for its entirety
- (ix) Gordon Avenue, for its entirety
- (x) Highcliffe Road, for its entirety
- (xi) Milland Road, for its entirety
- (xii) Nelson Road, for its entirety
- (xiii) Petersfield Road, for its entirety
- (xiv) Portal Road, for its entirety
- (xv) Quarry Road, from its junction with East Hill to its junction with Stratton Road.
- (xvi) St Catherine's Road, for its entirety
- (xvii) St Giles Close, for its entirety
- (xviii) St Leonard's Road, for its entirety
- (xix) Vale Road, for its entirety

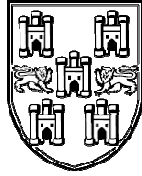

Winchester

City Council

TRAFFIC ORDER

Notice of Proposals of making of Various Road Traffic Orders Affecting the District of Winchester City Council

Winchester City Council as agents for Hampshire County Council proposes making the under-mentioned road traffic orders:-

1. **The Hampshire (Various Roads, Highcliffe, Winchester)(20 Miles per Hour Speed Limit) Order 2013**

The effect of this order will be to introduce a 20 mile per hour speed limit in various roads in Highcliffe, Winchester. Details are as follows:-

Road Name in Highcliffe	Parish	Traffic Restrictions Proposed
For the entirety of the road: Canute Road, Cathedral View, Chalk Ridge, Chesil Wood, Dell Road, East Hill, Fivefields Close, Fivefields Road, Gordon Avenue, Highcliffe Road, Milland Road, Nelson Road, Petersfield Road, Portal Road, St Catherine's Road, St Giles Close, St Leonard's Road, Vale Road Quarry Road: from its junction with East Hill to its junction with Stratton Road.	St John & All Saints	20 miles per hour speed limit

FURTHER DETAILS:

A copy of this notice, the proposed orders, maps showing the location and the effect of the proposals, a statement of reasons may be inspected during usual office hours at the following place:-

- City Offices, Colebrook Street, Winchester, SO23 9LJ

A copy of this notice and plan(s) showing extent of the proposal(s) are available to view online at:

www.winchester.gov.uk/roads-highways/traffic-regulation-orders

OBJECTIONS AND REPRESENTATIONS: All objections and other representations in respect of this proposal must state the grounds on which they are made, and be received by 13th November 2013.

Objections and representations may be sent to the undersigned by:

- Email to tro@winchester.gov.uk
- In writing to the undersigned below

Dated the 16th day of October 2013

H. N. Bone
Head of Legal Services
Winchester City Council
City Offices
Colebrook Street
Winchester
Hampshire
SO23 9LJ



Scan to view details of TRO'S
currently proposed by WCC

SCHEDULE

Roads at Highcliffe in the City of Winchester 20mph Speed Limit

- (i) Quarry Road between its junction with East Hill and its junction with Stratton Road.

And the following roads for their entire lengths:

- (ii) Canute Road
- (iii) Cathedral View
- (iv) Chalk Ridge
- (v) Chesil Wood
- (vi) Dell Road
- (vii) East Hill
- (viii) Fivefields Close
- (ix) Fivefields Road
- (x) Gordon Avenue
- (xi) Highcliffe Road
- (xii) Milland Road
- (xiii) Nelson Road
- (xiv) Petersfield Road
- (xv) Portal Road
- (xvii) St Catherine's Road
- (xviii) St Giles Close
- (xix) St Leonard's Road
- (xx) Vale Road