



PORTFOLIO HOLDER DECISION NOTICE

INDIVIDUAL DECISION BY THE PORTFOLIO HOLDER FOR BUILT ENVIRONMENT

TOPIC – TRAFFIC REGULATION ORDER – CROMWELL ROAD (BUNGALOWS) WINCHESTER

PROCEDURAL INFORMATION

The Access to Information Procedure Rules – Part 4, Section 22 of the Council's Constitution provides for a decision to be made by an individual member of Cabinet.

In accordance with the Procedure Rules, the Chief Operating Officer, the Chief Executive and the Chief Finance Officer are consulted together with Chairman and Vice Chairman of The Overview and Scrutiny Committee and any other relevant overview and scrutiny committee. In addition, all Members are notified.

If five or more Members from those informed so request, the Leader may require the matter to be referred to Cabinet for determination.

Contact Officers:

Case Officer: Neville Crisp – Traffic Engineer. Tel: 01962 848484. Email: ncrisp@winchester.gov.uk

Democratic Services Officer: Nancy Graham – Senior Democratic Services Officer. Tel: 01962 848235. Email: ngraham@winchester.gov.uk

SUMMARY

- Following instructions from WCC Housing revisions to the car parking at the Bungalows, Cromwell Road, Winchester are to be carried out. To prevent non-residents/commuters from parking all day in the new car park '2 hours limited waiting with permit holders exemption 8:00am to 6:00pm Monday to Saturday' restrictions were requested to be introduced.
- The proposed changes were advertised on 18th December 2013. Notices were posted on street in the immediate vicinity of the proposed changes, published in the Mid Hants Observer, placed on the Council's website and held on deposit in the City Office reception. No responses were received.
- The proposal is in keeping with the Corporate Priorities in its attempt to improve traffic management, road safety and the environment.

- The cost of implementing the proposal is funded through the Traffic Management Agency Agreement with Hampshire County Council. There will be no discernable additional enforcement costs.
- Copy of the plan showing the location and extent of the proposal is attached (Appendix 1).
- Copy of proposed schedule and statement of reasons is attached (Appendix 2).
- Copy of the proposal notice is attached (Appendix 3).
- Copy of the advertised order is attached (Appendix 4).

DECISION

- It is recommended to introduce restrictions as detailed in the schedule attached (Appendix 2).
- That the Head of Legal and Democratic Services be authorised to make the necessary order.

REASON FOR THE DECISION AND OTHER ALTERNATIVE OPTIONS CONSIDERED AND REJECTED

See Summary.

RESOURCE IMPLICATIONS:

- The cost of advertising and implementing the traffic regulation order is covered by the Traffic Management agreement with Hampshire County Council.
- No discernable increase in enforcement resources or costs is anticipated.

CONSULTATION UNDERTAKEN ON THE DECISION

- Requests for consent to proceed to formal advertisement was sent to all local Ward Members, County Councillor, Police and WCC Parking Office Manager and duly confirmed.
- Proposal notices were posted on street in the immediate vicinity of the proposed changes, published in the Mid Hants Observer, placed on the Council's website and held on deposit in the City Office reception.

**FURTHER ALTERNATIVE OPTIONS CONSIDERED AND REJECTED
FOLLOWING PUBLICATION OF THE DRAFT PORTFOLIO HOLDER DECISION
NOTICE**

N/A

**DECLARATION OF INTERESTS BY THE DECISION MAKER OR A MEMBER OR
OFFICER CONSULTED**

N/A

DISPENSATION GRANTED BY THE STANDARDS COMMITTEE

N/A

Approved by: (signature)

Date of Decision

13 March 2014

Councillor Weston – Portfolio Holder for Built Environment

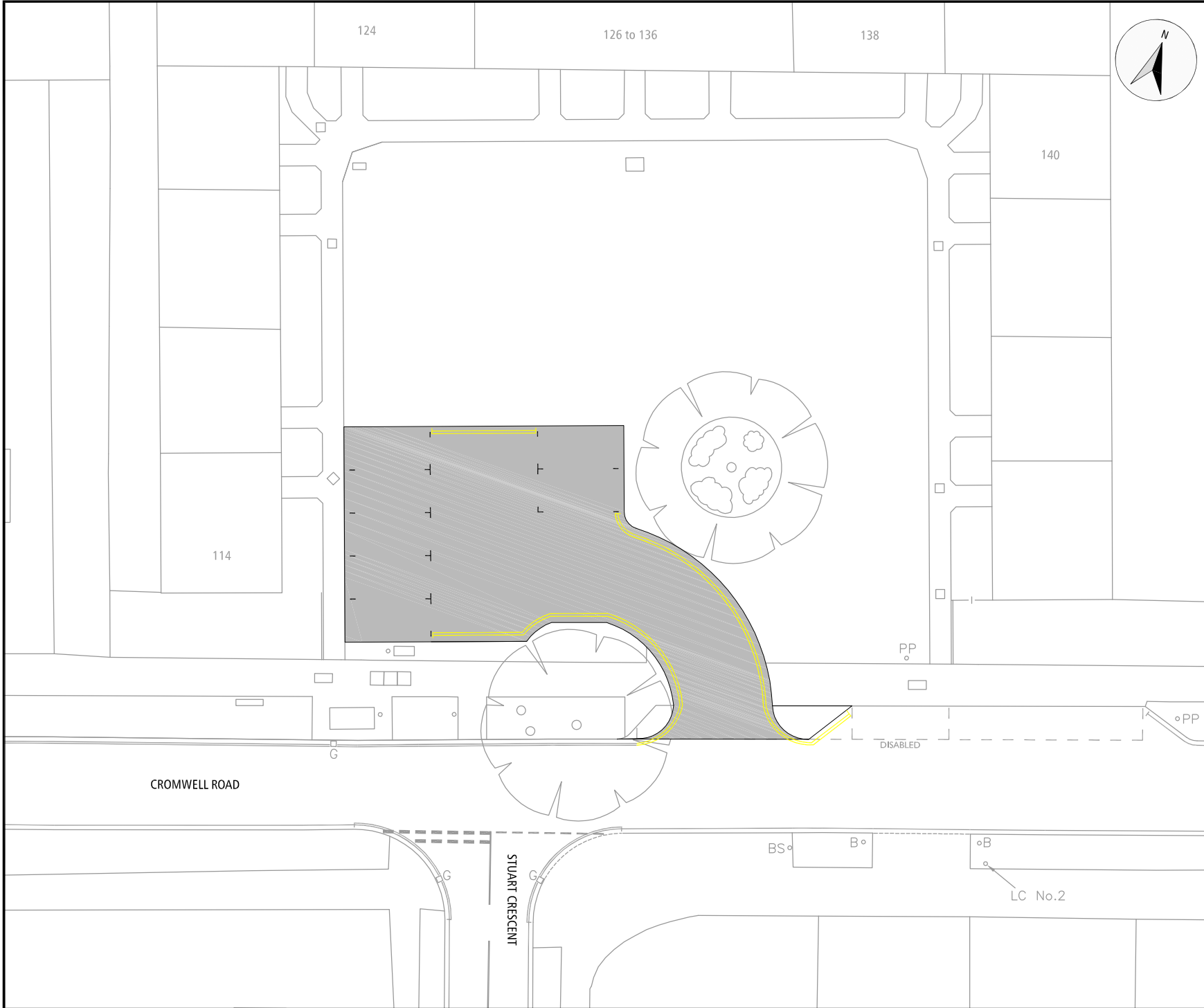

© Crown copyright and database rights 2012
Winchester City Council license 100019531



NEW PROPOSAL TO COVER 7No. NEW
PARKING BAYS. WITH TWO BAYS TO
BE LOST ON CROMWELL ROAD.

Rev.	Description	Date	Drawn
------	-------------	------	-------



Winchester
City Council

OPERATIONS GROUP
ACCESS & INFRASTRUCTURE

City Offices
Colebrook Street
Winchester,
SO23 9LJ.



© Winchester City Council

Project:
TRAFFIC MANAGEMENT
TRAFFIC REGULATION ORDER
PROPOSAL

Title:
NEW PROPOSAL
AIRLIE CORNER, STANMORE
WINCHESTER

Scale: 1:200 @ A3 Date: 30/10/13

Drawn: MCS Checked:

DRG. No. 810402/322/001 Status:

PROPOSED VARIATION TO

HAMPSHIRE COUNTY COUNCIL

ROAD TRAFFIC REGULATION ACT 1984

THE HAMPSHIRE (VARIOUS ROADS, WINCHESTER)
(PARKING PLACES AND RESTRICTION OF WAITING)
(CONTROLLED ZONE) (NO. 2) ORDER 2012 (VARIATION NO. XX) ORDER 2013

STATEMENT OF REASONS FOR REVISION

On traffic management grounds to maximise parking provision.

ITEMS TO BE DELETED

Schedule 1 Part 2
2 Hours Limited Waiting with Permit Holders Exemption
8.00 am to 6.00 pm Monday to Saturday

<u>Road Name</u>	<u>Side</u>	<u>Description</u>	<u>Zone</u>
CROMWELL ROAD	NORTH	BETWEEN A POINT 62.2 METRES WEST OF ITS JUNCTION WITH AIRLIE ROAD AND A POINT 49.2 METRES WEST OF THAT JUNCTION	2A

Schedule 2
No Waiting At Any Time

<u>Road Name</u>	<u>Side</u>	<u>Description</u>	<u>Zone</u>
CROMWELL ROAD	NORTH	BETWEEN A POINT 93.6 METRES WEST OF ITS JUNCTION WITH AIRLIE ROAD AND A POINT 62.2 METRES WEST OF THAT JUNCTION	2A

NEW ITEMS

Schedule 1 Part 5
Echelon Parking 2 Hours Limited Waiting with Permit Holders Exemption
8.00 am to 6.00 pm Monday to Saturday

<u>Road Name</u>	<u>Side</u>	<u>Description</u>	<u>Zone</u>
CROMWELL ROAD	OFF-ROAD PARKING AREA 114-143 CROMWELL ROAD	AS DRAWING NO. 810402/322/001. SEE ANNEXE A TO ORDER	2A

Schedule 2
No Waiting At Any Time

<u>Road Name</u>	<u>Side</u>	<u>Description</u>	<u>Zone</u>
CROMWELL ROAD	NORTH	BETWEEN A POINT 93.6 METRES WEST OF ITS JUNCTION WITH AIRLIE ROAD AND A POINT 49.2 METRES WEST OF THAT JUNCTION	2A
CROMWELL ROAD	OFF-ROAD PARKING AREA 114-143 CROMWELL ROAD	AS DRAWING NO. 810402/322/001. SEE ANNEXE A TO ORDER	2A



Winchester

City Council

TRAFFIC REGULATION ORDER

Notice of Proposals of making of Various Road Traffic Regulation Orders Affecting the District of Winchester City Council

Winchester City Council as agents for Hampshire County Council proposes making the undermentioned road traffic regulation orders:-

2. The Hampshire (Various Roads, Winchester) (Parking Places and Restriction of Waiting) (controlled Zone)(No.2) Order 2012 (Variation No. 5) Order 2014

The effect of this order will be to amend the no waiting area and introduce Echelon 2 hour limited waiting with permit holder exemptions in an off road parking area at 114 -143 Cromwell Road, Winchester. Details are as follows:-

Road Name	Parish	Traffic Restrictions Proposed
Off road parking area 114 – 143 Cromwell Road	St Luke	Echelon Parking 2 Hours limited waiting with Permit Holders exemption 8:00 am to 6:00 pm Monday to Saturday
Cromwell Road	St Luke	No Waiting

FURTHER DETAILS:

A copy of this notice, the proposed orders, maps showing the location and the effect of the proposals, a statement of reasons may be inspected during usual office hours at the following place:-

- City Offices, Colebrook Street, Winchester, SO23 9LJ

A copy of this notice and plan(s) showing extent of the proposal(s) are available to view online at:

www.winchester.gov.uk/roads-highways/traffic-regulation-orders

OBJECTIONS AND REPRESENTATIONS: All objections and other representations in respect of this proposal must state the grounds on which they are made, and be received by 30th January 2014.

Objections and representations may be sent to the undersigned by:

- Email to tro@winchester.gov.uk
- In writing to the undersigned below

Dated the 18th day of December 2013

H. N. Bone,
Head of Legal Services
Winchester City Council
City Offices
Colebrook Street
Winchester
Hampshire
SO23 9LJ
of TRO'S



Scan to view details

currently proposed by

WINCHESTER CITY COUNCIL

ROAD TRAFFIC REGULATION ACT 1984

THE HAMPSHIRE (VARIOUS ROADS WINCHESTER)
(PARKING PLACES AND RESTRICTION OF WAITING)
(CONTROLLED ZONE) (NO.2) ORDER (VARIATION No.5) 2014

Winchester City Council acting on behalf of Hampshire County Council in exercise of its powers under sections under Sections 1,2 4,32,35,45,46,49,51 and 53 of the Road Traffic Regulation Act 1984 (“ the Act”), as amended by the Road Traffic Regulation (Parking) Act 1986, Part IV of Schedule 9 to the Act , and of all other enabling powers, and after consultation with the Chief Officer of Police in accordance with Part III of Schedule 9 to the Act, hereby makes the following order :-

1. In this order the “Principal Order “ means The Hampshire (Various Roads Winchester) (Parking Places And Restriction Of Waiting) (Controlled Zone) (No.2) Order 2012 as amended.
2. The Principal Order shall have effect in that the items tabulated in Schedule 1 of this Order shall be removed from Schedule 1 Part 2 of the Principal Order.
3. The Principal Order shall have effect in that the items tabulated in Schedule 2 of this Order shall be removed from Schedule 2 of the Principal Order.
- 4.. The Principal Order shall have effect in that the items tabulated in Schedule 3 of this Order shall be inserted into Schedule 1 Part 5 of the Principal Order.
5. The Principal Order shall have effect in that the items tabulated in Schedule 4 of this Order shall be inserted into Schedule 2 of the Principal Order.
- 6.. This order may be cited as The Hampshire (Various Roads Winchester) (Parking Places And Restriction Of Waiting) (Controlled Zone) (No.2) Order (Variation No.5) 2014 and shall come into operation on the day of 2014.

Given this day of 2014

THE COMMON SEAL OF WINCHESTER)
CITY COUNCIL was hereunto affixed)
in the presence of :-)

Schedule 1

Items to be removed from
Schedule 1 Part 2
2 Hours Limited Waiting with Permit Holders Exemption
8.00 am to 6.00 pm Monday to Saturday

<u>Road Name</u>	<u>Side</u>	<u>Description</u>	<u>Zone</u>
CROMWELL ROAD	NORTH	BETWEEN A POINT 62.2 METRES WEST OF ITS JUNCTION WITH AIRLIE ROAD AND A POINT 49.2 METRES WEST OF THAT JUNCTION	2A

Schedule 2

Items to be removed from
Schedule 2
No Waiting At Any Time

<u>Road Name</u>	<u>Side</u>	<u>Description</u>	<u>Zone</u>
CROMWELL ROAD	NORTH	BETWEEN A POINT 93.6 METRES WEST OF ITS JUNCTION WITH AIRLIE ROAD AND A POINT 62.2 METRES WEST OF THAT JUNCTION	2A

Schedule 3

Items to be inserted into

Schedule 1 Part 5
Echelon Parking 2 Hours Limited Waiting with Permit Holders Exemption
8.00 am to 6.00 pm Monday to Saturday

<u>Road Name</u>	<u>Side</u>	<u>Description</u>	<u>Zone</u>
CROMWELL ROAD	OFF-ROAD PARKING AREA 114-143 CROMWELL ROAD	AS DRAWING NO. 810402/322/001. SEE ANNEXE A TO ORDER	2A

Schedule 4

Items to be inserted into

Schedule 2
No Waiting At Any Time

<u>Road Name</u>	<u>Side</u>	<u>Description</u>	<u>Zone</u>
CROMWELL ROAD	NORTH	BETWEEN A POINT 93.6 METRES WEST OF ITS JUNCTION WITH AIRLIE ROAD AND A POINT 49.2 METRES WEST OF THAT JUNCTION	2A
CROMWELL ROAD	OFF-ROAD PARKING AREA 114-143 CROMWELL ROAD	AS DRAWING NO. 810402/322/001. SEE ANNEXE A TO ORDER	2A