



PORTFOLIO HOLDER DECISION NOTICE

INDIVIDUAL DECISION BY THE PORTFOLIO HOLDER FOR ENVIRONMENT, HEALTH AND WELLBEING

TOPIC – TRAFFIC REGULATION ORDER – STANMORE LANE AREA, WINCHESTER

PROCEDURAL INFORMATION

The Access to Information Procedure Rules – Part 4, Section 22 of the Council's Constitution provides for a decision to be made by an individual member of Cabinet.

In accordance with the Procedure Rules, the Chief Operating Officer, the Chief Executive and the Chief Finance Officer are consulted together with Chairman and Vice Chairman of The Overview and Scrutiny Committee and any other relevant overview and scrutiny committee. In addition, all Members are notified.

If five or more Members from those informed so request, the Leader may require the matter to be referred to Cabinet for determination.

Contact Officers:

Case Officer: Neville Crisp – Traffic Engineer. Tel: 01962 848484. Email: ncrisp@winchester.gov.uk

Democratic Services Officer: Nancy Graham – Senior Democratic Services Officer. Tel: 01962 848235. Email: ngraham@winchester.gov.uk

SUMMARY

- In response to requests from residents and local Members regarding problems with displaced parking following the introduction of residents permit parking in lower Stanmore, it was proposed to consult on the possible extension of the residents' permit holders parking zone to include the section of Stanmore Lane between the railway bridge and Wavell Way and the cul-de-sacs along this length of road.
- As the proposal involved the introduction of residents' permit parking restrictions an informal consultation was carried out with all residents within the area of the potential extended zone to establish whether the restrictions would be supported by residents. As a result of this consultation the extent of the proposed zone was amended in agreement with the local Members.

- The proposed changes were advertised on 15th July 2015. Notices were posted on street in the immediate vicinity of the proposed changes, published in the Mid Hants Observer, placed on the Council's website and held on deposit in the City Office reception. All residents within the area of the proposed restrictions were letter dropped with a summary of the proposed restrictions and details of how to view the full documents.
- Two identical objections were received in response to the formal consultation, both stating that the proposed restrictions had been extended further than the informal consultation, which is not the case. These objections have not been resolved, however given that every property potentially affected was individually letter dropped as part of the formal consultation it is concluded that the majority of residents are happy with the extent of the proposed restrictions. The local Members have confirmed their support for the restrictions to be introduced as advertised.
- Minor changes to the existing restrictions in Paulet Place and Princes Place are also being included within the proposal. No representation were received in relation to these changes.
- The proposal is in keeping with the Corporate Priorities in its attempt to improve traffic management, road safety and the environment.
- The cost of implementing the proposal is funded through the Traffic Management Agency Agreement with Hampshire County Council. Any additional enforcement costs should be covered by additional income from permit fees.
- Copy of the plans showing the location and extent of the proposals are attached (Appendix 1).
- Copy of proposed schedule and statement of reasons is attached (Appendix 2).
- Copy of the proposal notice is attached (Appendix 3).
- Copy of the advertised order is attached (Appendix 4).

DECISION

1. That restrictions be introduced as detailed in the schedule attached (Appendix 2).
2. That the Head of Legal and Democratic Services be authorised to make the necessary order.

REASON FOR THE DECISION AND OTHER ALTERNATIVE OPTIONS CONSIDERED AND REJECTED

See Summary.

RESOURCE IMPLICATIONS:

- The cost of advertising and implementing the traffic regulation order is covered by the Traffic Management agreement with Hampshire County Council.
- No discernible increase in enforcement resources or costs is anticipated.

CONSULTATION UNDERTAKEN ON THE DECISION

- Requests for consent to proceed to formal advertisement was sent to all local Ward Members, County Councillor, Police and WCC Parking Office Manager and duly confirmed.
- Proposal notices were posted on street in the immediate vicinity of the proposed changes, published in the Mid Hants Observer, placed on the Council's website and held on deposit in the City Office reception.

FURTHER ALTERNATIVE OPTIONS CONSIDERED AND REJECTED FOLLOWING PUBLICATION OF THE DRAFT PORTFOLIO HOLDER DECISION NOTICE

N/A

DECLARATION OF INTERESTS BY THE DECISION MAKER OR A MEMBER OR OFFICER CONSULTED

N/A

DISPENSATION GRANTED BY THE STANDARDS COMMITTEE

N/A

Approved by: (signature)

Date of Decision 08.10.2015

Councillor Pearson – Portfolio Holder for Environment, Health and Wellbeing

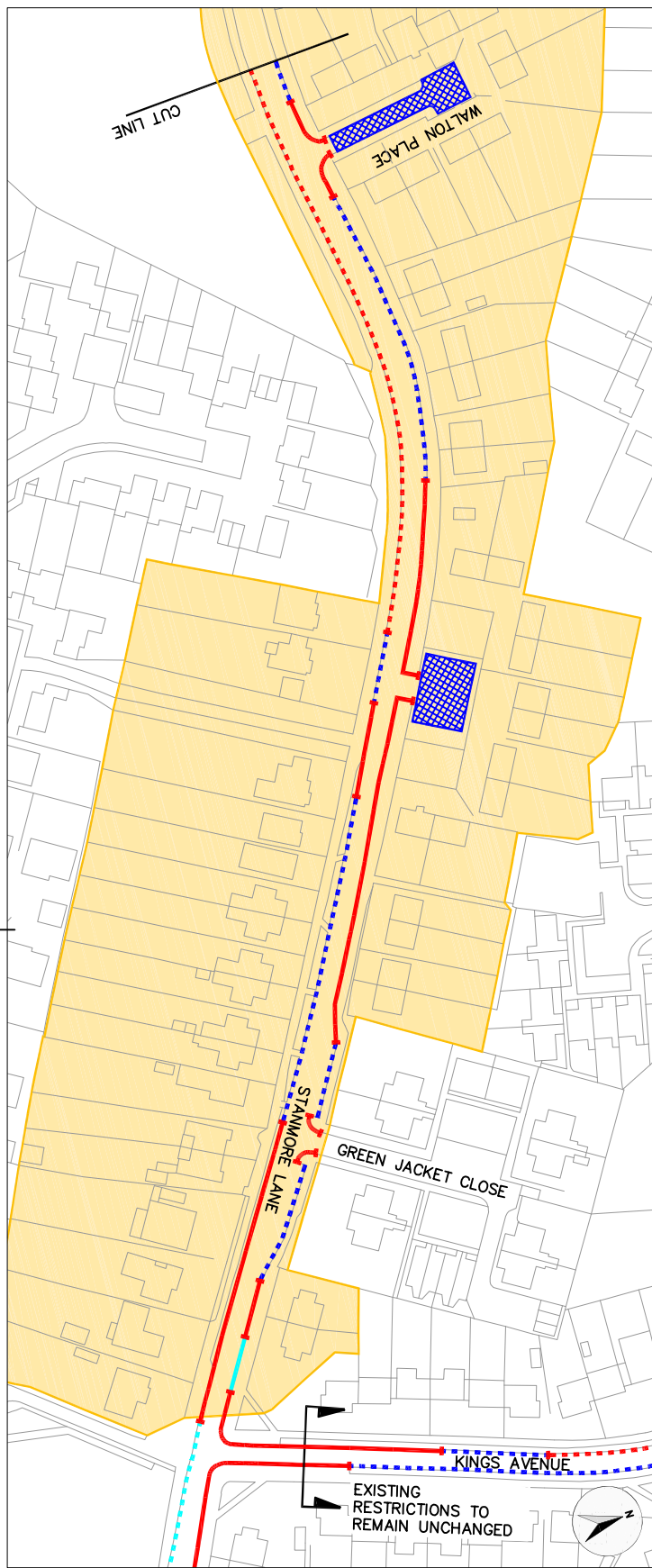
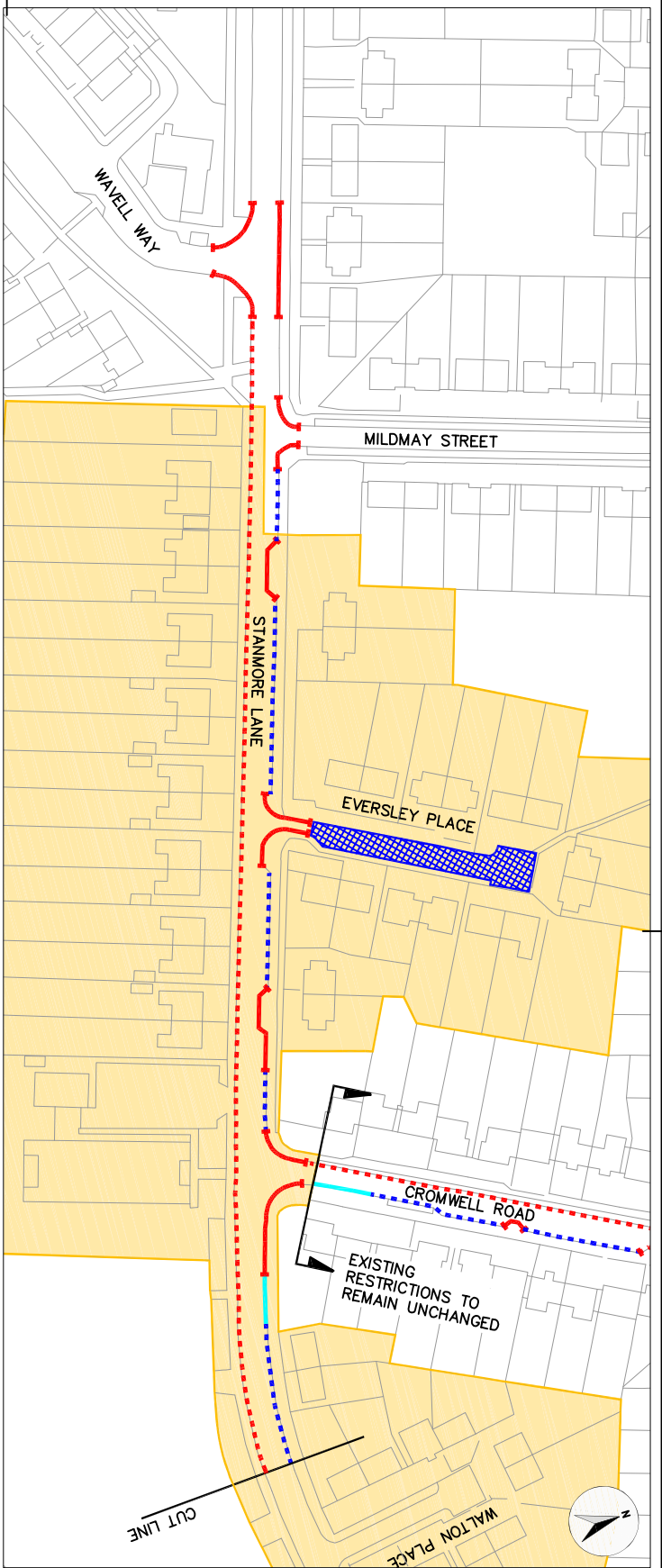

Rev	Description	Date	Drawn
1	Proposed waiting zones 2A	19/02/15	MCH
2	Revised waiting zones 2A	19/02/15	MCH
3	Final waiting zones 2A	19/02/15	MCH

	NO WAITING AT ANY TIME
	NO WAITING - MON - FRI 10am - 4pm
	2HR LIMITED WAITING EXCEPT FOR PERMIT HOLDERS 2A
	BUS STOPS
	SCHOOL KEEP CLEAR
	2HR LIMITED WAITING ZONES EXCEPT FOR PERMIT HOLDERS 2A
	PROPOSED EXTENSION TO PERMIT ZONE 2A
	No waiting Mon - Fri 10am - 4pm
	No shopping 7am - 7pm except buses
	No waiting Mon - Sat 8am - 9pm 2 hours Except for permit holders 2A

Winchester City Council

OPERATIONS GROUP
ENVIRONMENT
City Offices
Colebrook Street
Winchester,
SO23 9LL

Project: PERMANENT TRAFFIC REGULATION ORDERS

Title: PROPOSED WAITING RESTRICTIONS STANMORE LANE WINCHESTER

Scale: NTS @ A1	Date: 19/02/15
Drawn: MCH	Checked:
DRG. No. 810402/294/002	Status:

Key	Description	Date	Drawn
	NO WAITING AT ANY TIME (DOUBLE YELLOW LINES)		
	EXISTING NO WAITING RESTRICTIONS (DOUBLE YELLOW LINES) TO BE CHANGED TO NO WAITING 1:00PM TO 4:00PM MONDAY TO FRIDAY (SINGLE YELLOW LINES)		
	NO WAITING RESTRICTIONS TO BE CHANGED TO PERMITTED (SINGLE YELLOW LINES)		
	2 HOUR LIMITED WAITING PERMITTED WITH PERMITTED HOLDERS EXCEPT FROM 1:00PM TO 4:00PM MON TO SAT		
	DISABLED BAY - HOLDERS ONLY		

Winchester City Council

OPERATIONS GROUP
ENVIRONMENT
City Offices
Cobden Street
Winchester,
SO23 3LL

© Winchester City Council

Project:
TRAFFIC ORDERS
PERMANENT

Title:
PROPOSED WAITING RESTRICTIONS
PAULET PLACE

**INTRODUCTION OF
ADDITIONAL PARKING BAYS**

Scale: 1:500
Date: 16/03/2015

Drawn: NVC
Checked:
DRG. No.: 810402/294/003
Status:

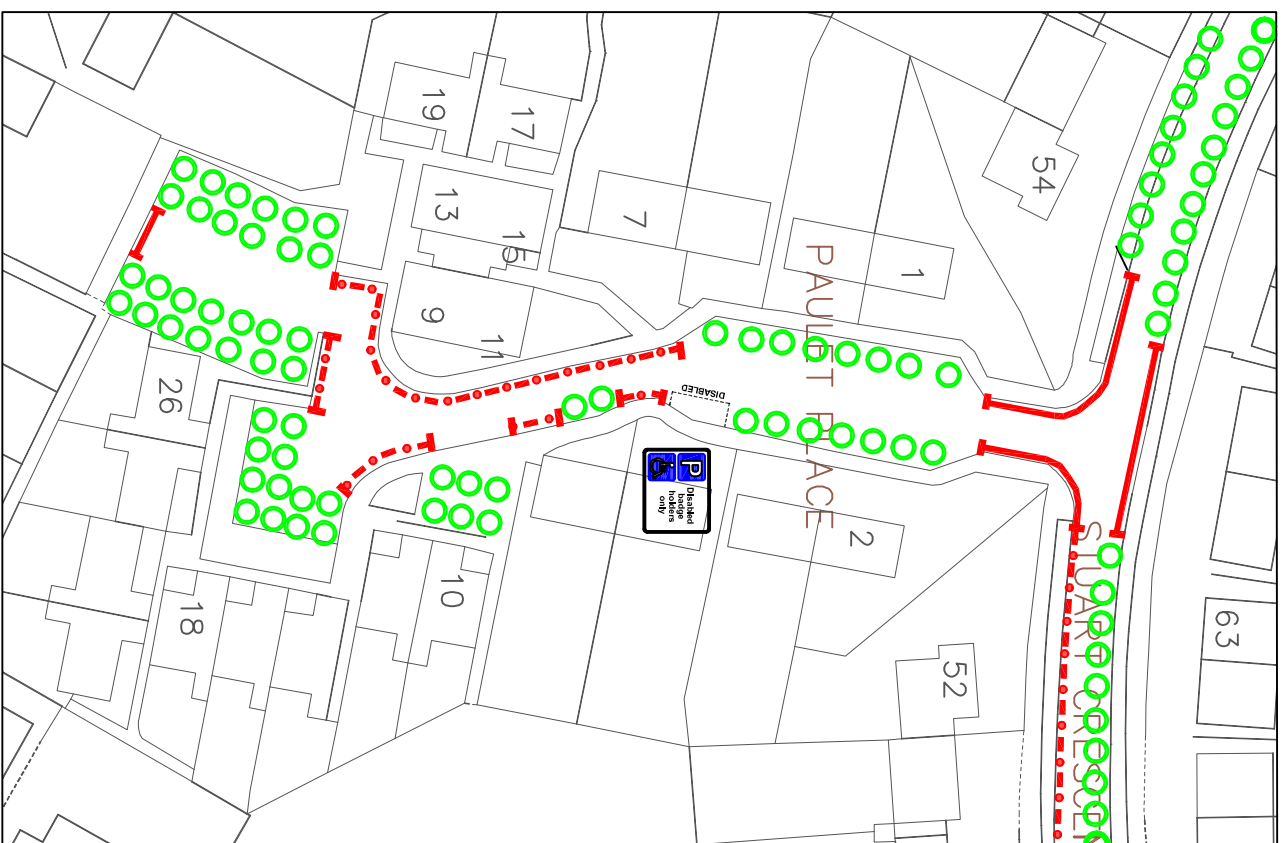

PROPOSED RESTRICTIONS

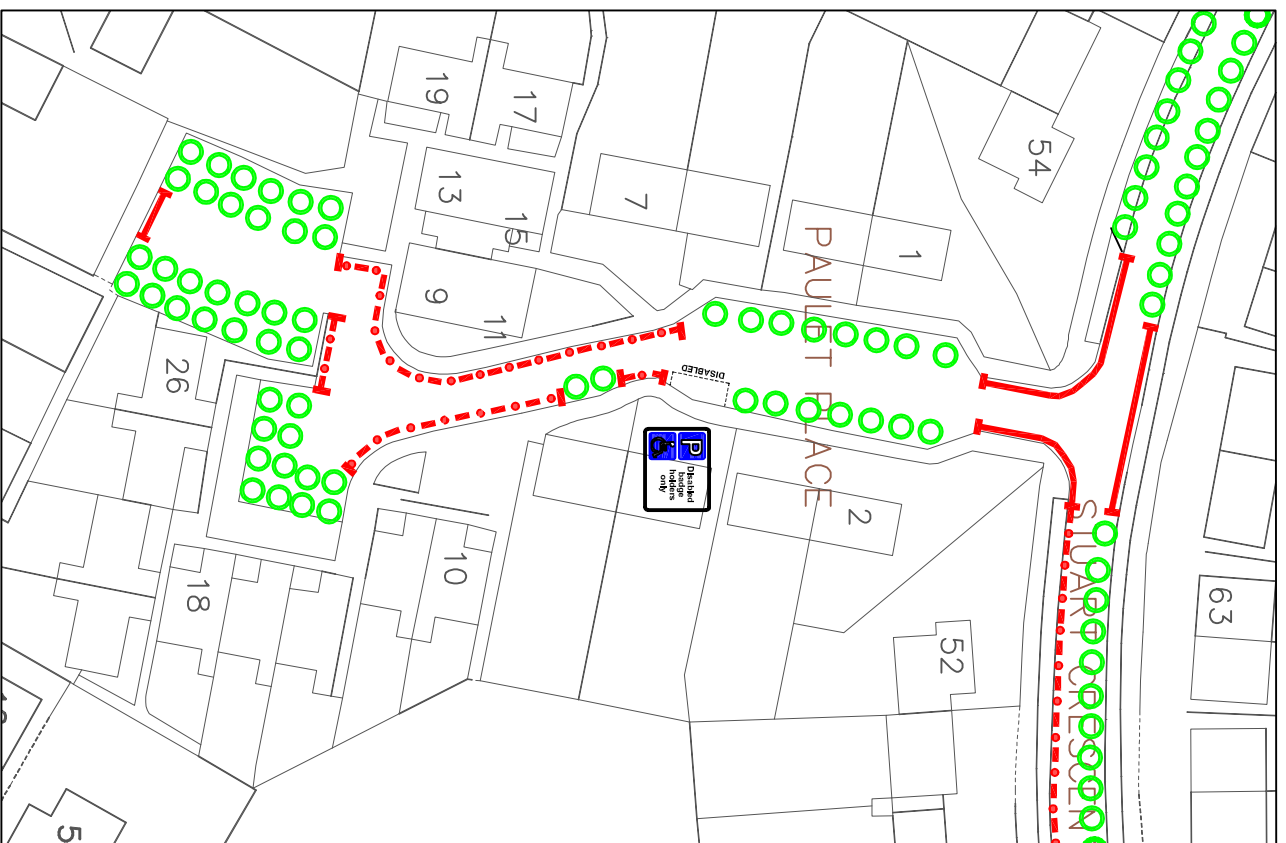

EXISTING RESTRICTIONS

- NO WAITING AT ALL TIME (SINGLE YELLOW LINES)
- EXCEPT NO WAITING FROM 10.00am MONDAY TO 4.00pm MONDAY TO FRIDAY
- NO WAITING FROM 10.00am MONDAY TO 4.00pm MONDAY TO FRIDAY (SINGLE YELLOW LINES)
- PARKING LIMITED WAITING PERMITTED WITHIN THE INDICATED AREA FROM 10.00am MONDAY TO 4.00pm MONDAY TO FRIDAY (SINGLE YELLOW LINES)
- DISABLED BADGE HOLDERS ONLY

Row	Description	Date/Drawn



OPERATIONS GROUP
ENVIRONMENT
City Offices
Colebrook Street
Winchester,
SO23 9LJ.



Project: TRAFFIC ORDERS PERMANENT

Title: PROPOSED WAITING RESTRICTIONS PRINCES PLACE

REMOVAL OF PARKING BAY

Scalents	Date: 12/05/2015
Drawn: hVC	Checked:
Dwg. No. 810402/294/004	Status:

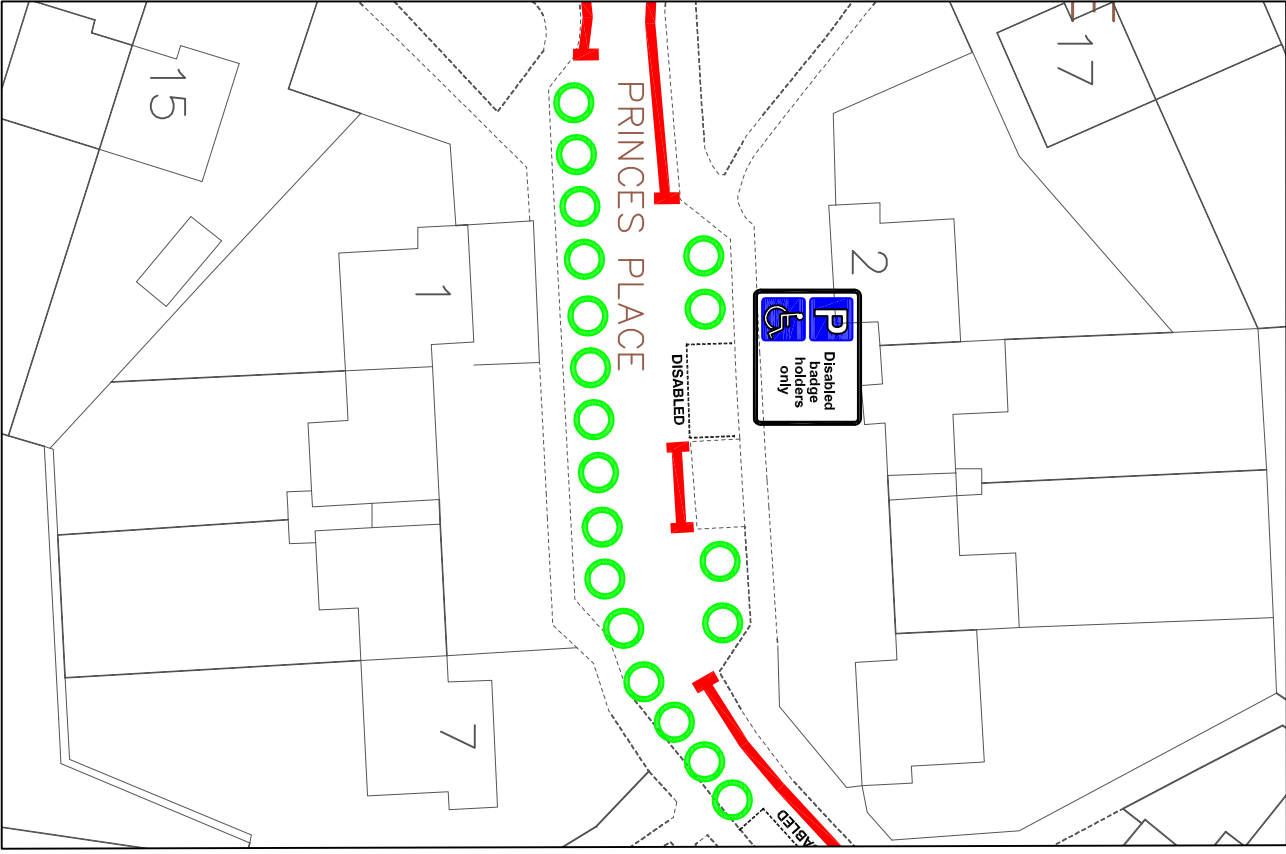

PROPOSED RESTRICTIONS

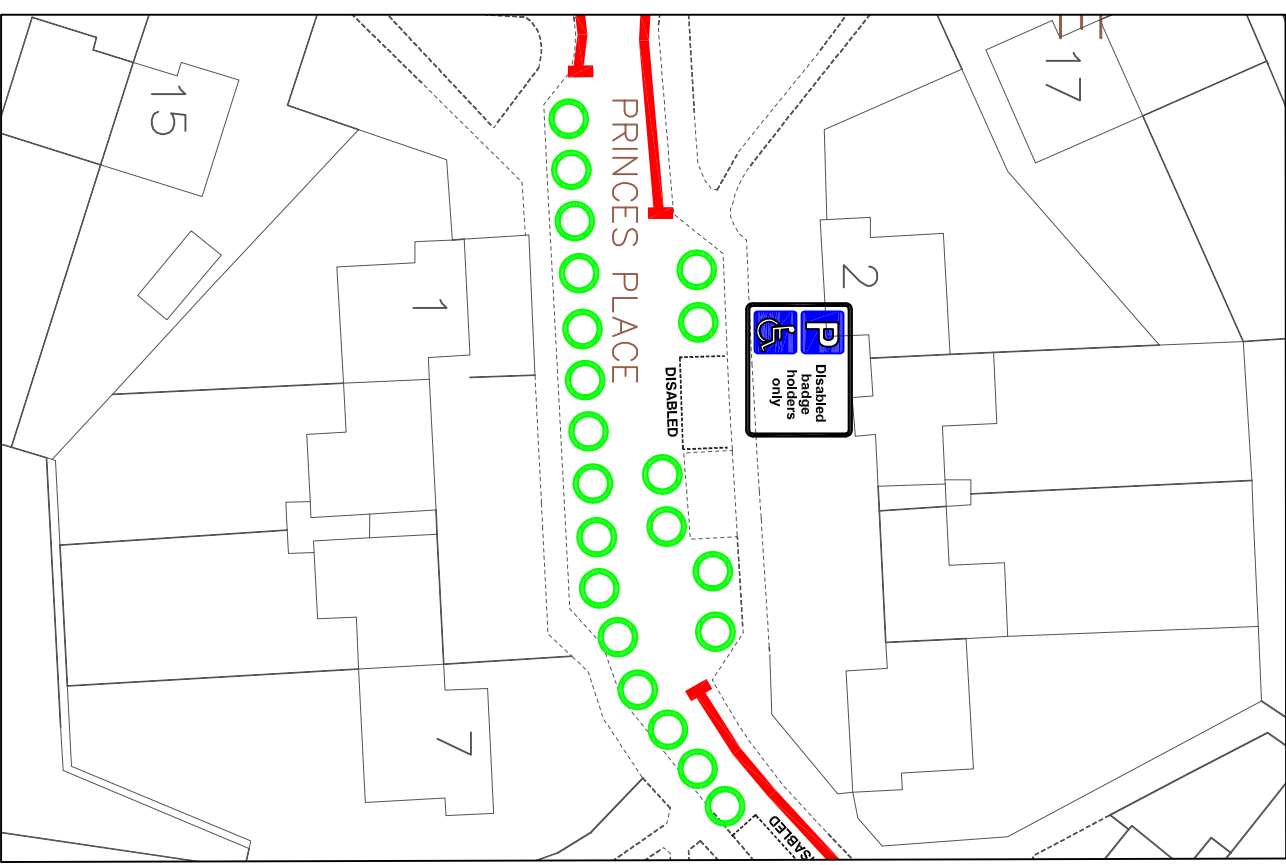

EXISTING RESTRICTIONS

PROPOSED VARIATION TO:-

HAMPSHIRE COUNTY COUNCIL

ROAD TRAFFIC REGULATION ACT 1984

THE HAMPSHIRE (VARIOUS ROADS, WINCHESTER)
(PARKING PLACES AND RESTRICTION OF WAITING)
(CONTROLLED ZONE) (NO. 2) ORDER 2012

STATEMENT OF REASONS FOR REVISION:-

The proposals are to address issues of visibility, obstruction and/or to increase on-street parking provision. There is a significant problem with commuter and long-term non-residents that park in the area. Consequently the extension/introduction of residents permit parking and limited waiting restrictions should help diffuse the existing parking problems.

EXISTING ITEMS TO BE DELETED FROM:-

HAMPSHIRE COUNTY COUNCIL
ROAD TRAFFIC REGULATION ACT 1984
THE HAMPSHIRE (VARIOUS ROADS, WINCHESTER)
(PARKING PLACES AND RESTRICTION OF WAITING)
(NO. 2) ORDER 2001 (VARIATION NO. 20) ORDER 2007

SCHEDULE II
No Waiting At Any Time

<u>Road Name</u>	<u>Side</u>	<u>Description</u>	<u>Zone</u>
STANMORE LANE	NORTH	BETWEEN A POINT 5.0 METRES EAST OF ITS JUNCTION WITH WALTON PLACE AND A POINT 5.0 METRES WEST OF THAT JUNCTION.	2A
STANMORE LANE	NORTH	BETWEEN A POINT 10.0 METRES EAST OF ITS JUNCTION WITH CROMWELL ROAD AND A POINT 10.0 METRES WEST OF THAT JUNCTION.	2A
STANMORE LANE	NORTH	BETWEEN A POINT 8.0 METRES EAST OF ITS JUNCTION WITH EVERSLEY PLACE AND A POINT 4.0 METRES WEST OF THAT JUNCTION.	2A

HAMPSHIRE COUNTY COUNCIL
ROAD TRAFFIC REGULATION ACT 1984
THE HAMPSHIRE (VARIOUS ROADS, WINCHESTER)
(PARKING PLACES AND RESTRICTION OF WAITING)
(CONTROLLED ZONE) (NO. 2) ORDER 2012

SCHEDULE 1 Pt XVIII
2 Hour Limited Waiting With Permit Holders Exemption 8:00am to 6:00pm Monday to Saturday

<u>Road Name</u>	<u>Side</u>	<u>Description</u>	<u>Zone</u>
PRINCES PLACE - SPINE	NORTH	BETWEEN A POINT 29.6 METRES EAST OF ITS JUNCTION WITH KINGS AVENUE AND A POINT 42.8 METRES EAST OF THAT JUNCTION.	2A

SCHEDULE XII
No Waiting 10:00am to 4:00pm Monday to Friday

<u>Road Name</u>	<u>Side</u>	<u>Description</u>	<u>Zone</u>
PAULET PLACE – SPINE	EAST	BETWEEN A POINT 50.8 METRES SOUTH OF ITS JUNCTION WITH STUART CRESCENT AND A POINT 72.2 METRES SOUTH OF THAT JUNCTION.	2A

NEW ITEMS FOR CONTROLLED ZONE NO. 2 ORDER

SCHEDULE II **No Waiting At Any Time**

<u>Road Name</u>	<u>Side</u>	<u>Description</u>	<u>Zone</u>
EVERSLEY PLACE	BOTH	BETWEEN ITS JUNCTION WITH STANMORE LANE AND A POINT 10.0 METRES NORTH THAT JUNCTION.	2A
PRINCES PLACE - SPINE	NORTH	BETWEEN A POINT 29.6 METRES EAST OF ITS JUNCTION WITH KINGS AVENUE AND A POINT 34.5 METRES EAST OF THAT JUNCTION.	2A
STANMORE LANE	NORTH	BETWEEN A POINT 21.3 METRES WEST OF ITS JUNCTION WITH GREEN JAKCET CLOSE AND A POINT 157.5 METRES WEST OF THAT JUNCTION.	2A
STANMORE LANE	NORTH	BETWEEN A POINT 10.8 METRES EAST OF ITS JUNCTION WITH WALTON PLACE AND A POINT 10.8 METRES WEST OF THAT JUNCTION.	2A
STANMORE LANE	NORTH	BETWEEN A POINT 21.0 METRES EAST OF ITS JUNCTION WITH CROMWELL ROAD AND A POINT 9.5 METRES WEST OF THAT JUNCTION.	2A
STANMORE LANE	NORTH	BETWEEN A POINT 21.0 METRES WEST OF ITS JUNCTION WITH CROMWELL ROAD AND A POINT 38.5 METRES WEST OF THAT JUNCTION.	2A
STANMORE LANE	NORTH	BETWEEN A POINT 10.0 METRES EAST OF ITS JUNCTION WITH EVERSLEY PLACE AND A POINT 4.5 METRES WEST OF THAT JUNCTION.	2A
STANMORE LANE	NORTH	BETWEEN A POINT 50.7 METRES WEST OF ITS JUNCTION WITH EVERSLEY PLACE AND A POINT 63.9 METRES WEST OF THAT JUNCTION.	2A
STANMORE LANE	SOUTH	BETWEEN A POINT 435.8 METRES EAST OF ITS JUNCTION WITH WAVELL WAY AND A POINT 457.5 METRES EAST OF THAT JUNCTION.	2A
STANMORE LANE	SOUTH	BETWEEN A POINT 533.0 METRES EAST OF ITS JUNCTION WITH WAVELL WAY AND A POINT 555.0 METRES EAST OF THAT JUNCTION.	2A

SCHEDULE X **No Stopping 7:00am to 7:00pm Except Buses**

<u>Road Name</u>	<u>Side</u>	<u>Description</u>	<u>Zone</u>
STANMORE LANE	NORTH	BETWEEN A POINT 21.0 METRES EAST OF ITS JUNCTION WITH CROMWELL ROAD AND A POINT 35.0 METRES EAST OF THAT JUNCTION.	2A

SCHEDULE XII

No Waiting 10:00am to 4:00pm Monday to Friday

<u>Road Name</u>	<u>Side</u>	<u>Description</u>	<u>Zone</u>
PAULET PLACE – SPINE	EAST	BETWEEN A POINT 50.8 METRES SOUTH OF ITS JUNCTION WITH STUART CRESCENT AND A POINT 56.0 METRES SOUTH OF THAT JUNCTION.	2A
PAULET PLACE - SPINE	EAST	BETWEEN A POINT 63.9 METRES SOUTH OF ITS JUNCTION WITH STUART CRESCENT AND A POINT 72.2 METRES SOUTH OF THAT JUNCTION.	2A
STANMORE LANE	SOUTH	BETWEEN A POINT 9.0 METRES EAST OF ITS JUNCTION WITH WAVELL WAY AND A POINT 419.8 METRES EAST OF THAT JUNCTION.	2A

SCHEDULE 1 Pt XVIII

2 Hour Limited Waiting With Permit Holders Exemption 8:00am to 6:00pm Monday to Saturday

<u>Road Name</u>	<u>Side</u>	<u>Description</u>	<u>Zone</u>
EVERSLEY PLACE	BOTH	BETWEEN AT POINT 12.5 METRES NORTH OF ITS JUNCTION WITH STANMORE LANE AND A POINT 64.0 NORTH OF THAT JUNCTION.	2A
PRINCES PLACE - SPINE	NORTH	BETWEEN A POINT 34.5 METRES EAST OF ITS JUNCTION WITH KINGS AVENUE AND A POINT 42.8 METRES EAST OF THAT JUNCTION.	2A
STANMORE LANE	NORTH	BETWEEN A POINT 44.0 METRES WEST OF ITS JUNCTION WITH KINGS AVENUE AND A POINT 3.2 METRES EAST OF ITS JUNCTION WITH GREEN JACKET CLOSE.	2A
STANMORE LANE	NORTH	BETWEEN A POINT 3.0 METRES WEST OF ITS JUNCTION WITH GREEN JACKET CLOSE AND A POINT 21.3 METRES WEST OF THAT JUNCTION.	2A
STANMORE LANE	NORTH	BETWEEN A POINT 157.5 METRES WEST OF ITS JUNCTION WITH GREEN JACKET CLOSE AND A POINT 10.8 METRES EAST OF ITS JUNCTION WITH WALTON PLACE.	2A
STANMORE LANE	NORTH	BETWEEN A POINT 10.8 METRES WEST OF ITS JUNCTION WITH WALTON PLACE AND A POINT 35.0 METRES EAST OF ITS JUNCTION WITH CROMWELL ROAD.	2A
STANMORE LANE	NORTH	BETWEEN A POINT 9.5 METRES WEST OF ITS JUNCTION WITH CROMWELL ROAD AND A POINT 21.0 METRES WEST OF THAT JUNCTION.	2A
STANMORE LANE	NORTH	BETWEEN A POINT 38.5 METRES WEST OF ITS JUNCTION WITH CROMWELL ROAD AND A POINT 10.0 METRES EAST OF ITS JUNCTION WITH EVERSLEY PLACE.	2A
STANMORE LANE	NORTH	BETWEEN A POINT 4.5 METRES EAST OF ITS JUNCTION WITH EVERSELEY PLACE AND A POINT 50.7 METRES WEST OF THAT JUNCTION.	2A

<u>Road Name</u>	<u>Side</u>	<u>Description</u>	<u>Zone</u>
STANMORE LANE	NORTH	BETWEEN A POINT 63.9 METRES WEST OF ITS JUNCTION WITH EVERSELY PLACE AND A POINT 6.0 METRES EAST OF ITS JUNCTION WITH MILDWAY STREET.	2A
STANMORE LANE	SOUTH	BETWEEN A POINT 419.8 METRES EAST OF ITS JUNCTION WITH WAVELL WAY AND A POINT 435.8 METRES EAST OF THAT JUNCTION.	2A
STANMORE LANE	SOUTH	BETWEEN A POINT 457.5 METRES EAST OF ITS JUNCTION WITH WAVELL WAY AND A POINT 533.0 METRES WEST OF ITS JUNCTION WITH KINGS AVENUE.	2A
WALTON PLACE	BOTH	BETWEEN A POINT 5.2 METRES NORTH OF ITS JUNCTION WITH STANMORE LANE AND A POINT 37.8 METRES NORTH OF THAT JUNCTION.	2A

NEW SCHEDULE

Echelon Parking 2 Hour Limited Waiting With Permit Holders Exemption 8:00am to 6:00pm Monday to Saturday

<u>Road Name</u>	<u>Side</u>	<u>Description</u>	<u>Zone</u>
PAULET PLACE – SPINE	EAST	BETWEEN A POINT 56.0 METRES SOUTH OF ITS JUNCTION WITH STUART CRESCENT AND A POINT 63.9 METRES SOUTH OF THAT JUNCTION	2A



Winchester

City Council

TRAFFIC REGULATION ORDER

Notice of Proposals of making of Various Road Traffic Regulation Orders Affecting the District of Winchester City Council

Winchester City Council as agents for Hampshire County Council proposes making the undermentioned road traffic regulation orders:-

The Hampshire (Various Roads Winchester) (Parking Places and Restriction of Waiting) (Controlled Zone) (No.2) Order 2012 (Variation No. 7) 2015

The effect of this order will be to introduce no waiting, no stopping and permit holder provisions in the Stanmore area of Winchester. Details are as follows:-

Parish	Road Name	Traffic Restrictions Proposed
St Luke Ward	Eversley Place, Winchester	Introduction of 2 Hours Limited Waiting with Permit Holders Exemption 8:00am to 6:00pm Monday to Saturday parking bays.
	Princes Place, Winchester	
	Stanmore Lane, Winchester	
	Walton Place, Winchester	
	Paulet Place, Winchester	Introduction of Echelon Parking 2 Hours Limited Waiting with Permit Holders Exemption 8:00am to 6:00pm Monday to Saturday parking bays.
	Eversley Place, Winchester	Introduction of double yellow line No Waiting At Any Time restrictions.
	Princes Place, Winchester	
	Stanmore Lane, Winchester	
	Stanmore Lane, Winchester	Introduction of single yellow line No Waiting 10:00am to 4:00pm Monday to Friday restrictions.
	Stanmore Lane, Winchester	Introduction of No Stopping Except Buses 7:00am to 7:00pm restrictions.

FURTHER DETAILS:

A copy of this notice, the proposed orders, maps showing the location and the effect of the proposals, a statement of reasons may be inspected during usual office hours at the following place:-

- City Offices, Colebrook Street, Winchester, SO23 9LJ

A copy of this notice and plan(s) showing extent of the proposal(s) are available to view online at:

www.winchester.gov.uk/roads-highways/traffic-regulation-orders

OBJECTIONS AND REPRESENTATIONS: All objections and other representations in respect of this proposal must state the grounds on which they are made, and be received by 14th August 2015.

Objections and representations may be sent to the undersigned by:

- Email to tro@winchester.gov.uk
- In writing to the undersigned below

Dated the 15th day of July 2015

H. N. Bone,
Head of Legal and Democratic Services
Winchester City Council
City Offices
Colebrook Street
Winchester
Hampshire
SO23 9LJ



Scan to view details of TRO'S
currently proposed by WCC

WINCHESTER CITY COUNCIL
ROAD TRAFFIC REGULATION ACT 1984
THE HAMPSHIRE (VARIOUS ROADS WINCHESTER)
(PARKING PLACES AND RESTRICTION OF WAITING)
(CONTROLLED ZONE) (NO.2) ORDER 2012 (VARIATION No.7) 2014

Winchester City Council acting on behalf of Hampshire County Council in exercise of its powers under sections under Sections 1,2 4,32,35,45,46,49,51 and 53 of the Road Traffic Regulation Act 1984 (" the Act"), as amended by the Road Traffic Regulation (Parking) Act 1986, Part IV of Schedule 9 to the Act , and of all other enabling powers, and after consultation with the Chief Officer of Police in accordance with Part III of Schedule 9 to the Act, hereby makes the following order :-

- 1.. In this order the "Principal Order " means The Hampshire (Various Roads Winchester) (Parking Places And Restriction Of Waiting) (Controlled Zone) (No.2) Order 2012 as amended.
- 2 The Principal Order shall have effect in that the items tabulated in Schedule 1 of this Order shall be removed from Schedule I Part XVII of the Principal Order
3. The Principal Order shall have effect in that the items tabulated in Schedule 1 of this Order shall be removed from Schedule XII of the Principal Order
4. The Items tabulated in Schedule 3 of this Order are hereby removed from Schedule II of the Hampshire (Various Roads, Winchester) (Parking Places and Restriction of Waiting)(no.2) Order 2001 inserted by Variation 20 of that Order.
5. The Principal Order shall have effect in that the items tabulated in Schedule 4 of this Order shall be inserted into Schedule II of the Principal Order
6. The Principal Order shall have effect in that the items tabulated in Schedule 5 of this Order shall be inserted into Schedule X of the Principal Order
7. The Principal Order shall have effect in that the items tabulated in Schedule 6 of this Order shall be inserted into Schedule XII of the Principal Order
8. The Principal Order shall have effect in that the items tabulated in Schedule 7 of this

Order shall be inserted into Schedule I Part XVIII of the Principal Order

9. The Principal Order shall have effect in that the items tabulated in Schedule 8 of this Order shall be inserted as Schedule I Part 2A of the Principal Order

4. This order may be cited as The Hampshire (Various Roads Winchester) (Parking Places And Restriction Of Waiting) (Controlled Zone) (No.2) Order 2012 (Variation No.7) 2015 and shall come into operation on the day of 2015

Schedule 1

2 Hour Limited Waiting With Permit Holders Exemption 8:00am to 6:00pm Monday to Saturday

<u>Road Name</u>	<u>Side</u>	<u>Description</u>	<u>Zone</u>
PRINCES PLACE - SPINE	NORTH	BETWEEN A POINT 29.6 METRES EAST OF ITS JUNCTION WITH KINGS AVENUE AND A POINT 42.8 METRES EAST OF THAT JUNCTION.	2A

Schedule 2

No Waiting 10:00am to 4:00pm Monday to Friday

<u>Road Name</u>	<u>Side</u>	<u>Description</u>	<u>Zone</u>
PAULET PLACE – SPINE	EAST	BETWEEN A POINT 50.8 METRES SOUTH OF ITS JUNCTION WITH STUART CRESCENT AND A POINT 72.2 METRES SOUTH OF THAT JUNCTION.	2A

Schedule 3

No Waiting At Any Time

<u>Road Name</u>	<u>Side</u>	<u>Description</u>	<u>Zone</u>
STANMORE LANE	NORTH	BETWEEN A POINT 5.0 METRES EAST OF ITS JUNCTION WITH WALTON PLACE AND A POINT 5.0 METRES WEST OF THAT JUNCTION.	2A
STANMORE LANE	NORTH	BETWEEN A POINT 10.0 METRES EAST OF ITS JUNCTION WITH CROMWELL ROAD AND A POINT 10.0 METRES WEST OF THAT JUNCTION.	2A
STANMORE LANE	NORTH	BETWEEN A POINT 8.0 METRES EAST OF ITS JUNCTION WITH EVERSLEY PLACE AND A POINT 4.0 METRES WEST OF THAT JUNCTION.	2A

Schedule 4

SCHEDULE II
No Waiting At Any Time

<u>Road Name</u>	<u>Side</u>	<u>Description</u>	<u>Zone</u>
EVERSLEY PLACE	BOTH	BETWEEN ITS JUNCTION WITH STANMORE LANE AND A POINT 10.0 METRES NORTH THAT JUNCTION.	2A
PRINCES PLACE - SPINE	NORTH	BETWEEN A POINT 29.6 METRES EAST OF ITS JUNCTION WITH KINGS AVENUE AND A POINT 34.5 METRES EAST OF THAT JUNCTION.	2A
STANMORE LANE	NORTH	BETWEEN A POINT 21.3 METRES WEST OF ITS JUNCTION WITH GREEN JAKCET CLOSE AND A POINT 157.5 METRES WEST OF THAT JUNCTION.	2A

<u>Road Name</u>	<u>Side</u>	<u>Description</u>	<u>Zone</u>
STANMORE LANE	NORTH	BETWEEN A POINT 10.8 METRES EAST OF ITS JUNCTION WITH WALTON PLACE AND A POINT 10.8 METRES WEST OF THAT JUNCTION.	2A
STANMORE LANE	NORTH	BETWEEN A POINT 21.0 METRES EAST OF ITS JUNCTION WITH CROMWELL ROAD AND A POINT 9.5 METRES WEST OF THAT JUNCTION.	2A
STANMORE LANE	NORTH	BETWEEN A POINT 21.0 METRES WEST OF ITS JUNCTION WITH CROMWELL ROAD AND A POINT 38.5 METRES WEST OF THAT JUNCTION.	2A
STANMORE LANE	NORTH	BETWEEN A POINT 10.0 METRES EAST OF ITS JUNCTION WITH EVERSLEY PLACE AND A POINT 4.5 METRES WEST OF THAT JUNCTION.	2A
STANMORE LANE	NORTH	BETWEEN A POINT 50.7 METRES WEST OF ITS JUNCTION WITH EVERSLEY PLACE AND A POINT 63.9 METRES WEST OF THAT JUNCTION.	2A
STANMORE LANE	SOUTH	BETWEEN A POINT 435.8 METRES EAST OF ITS JUNCTION WITH WAVELL WAY AND A POINT 457.5 METRES EAST OF THAT JUNCTION.	2A
STANMORE LANE	SOUTH	BETWEEN A POINT 533.0 METRES EAST OF ITS JUNCTION WITH WAVELL WAY AND A POINT 555.0 METRES EAST OF THAT JUNCTION.	2A

Schedule 5

SCHEDULE X

No Stopping 7:00am to 7:00pm Except Buses

<u>Road Name</u>	<u>Side</u>	<u>Description</u>	<u>Zone</u>
STANMORE LANE	NORTH	BETWEEN A POINT 21.0 METRES EAST OF ITS JUNCTION WITH CROMWELL ROAD AND A POINT 35.0 METRES EAST OF THAT JUNCTION.	2A

Schedule 6

SCHEDULE XII

No Waiting 10:00am to 4:00pm Monday to Friday

<u>Road Name</u>	<u>Side</u>	<u>Description</u>	<u>Zone</u>
PAULET PLACE – SPINE	EAST	BETWEEN A POINT 50.8 METRES SOUTH OF ITS JUNCTION WITH STUART CRESCENT AND A POINT 56.0 METRES SOUTH OF THAT JUNCTION.	2A
PAULET PLACE - SPINE	EAST	BETWEEN A POINT 63.9 METRES SOUTH OF ITS JUNCTION WITH STUART CRESCENT AND A POINT 72.2 METRES SOUTH OF THAT JUNCTION.	2A
STANMORE LANE	SOUTH	BETWEEN A POINT 9.0 METRES EAST OF ITS JUNCTION WITH WAVELL WAY AND A POINT 419.8 METRES EAST OF THAT JUNCTION.	2A

Schedule 7

SCHEDULE 1 Pt XVIII

2 Hour Limited Waiting With Permit Holders Exemption 8:00am to 6:00pm Monday to Saturday

<u>Road Name</u>	<u>Side</u>	<u>Description</u>	<u>Zone</u>
EVERSLEY PLACE	BOTH	BETWEEN AT POINT 12.5 METRES NORTH OF ITS JUNCTION WITH STANMORE LANE AND A POINT 64.0 NORTH OF THAT JUNCTION.	2A
PRINCES PLACE - SPINE	NORTH	BETWEEN A POINT 34.5 METRES EAST OF ITS JUNCTION WITH KINGS AVENUE AND A POINT 42.8 METRES EAST OF THAT JUNCTION.	2A
STANMORE LANE	NORTH	BETWEEN A POINT 44.0 METRES WEST OF ITS JUNCTION WITH KINGS AVENUE AND A POINT 3.2 METRES EAST OF ITS JUNCTION WITH GREEN JACKET CLOSE.	2A
STANMORE LANE	NORTH	BETWEEN A POINT 3.0 METRES WEST OF ITS JUNCTION WITH GREEN JACKET CLOSE AND A POINT 21.3 METRES WEST OF THAT JUNCTION.	2A
STANMORE LANE	NORTH	BETWEEN A POINT 157.5 METRES WEST OF ITS JUNCTION WITH GREEN JACKET CLOSE AND A POINT 10.8 METRES EAST OF ITS JUNCTION WITH WALTON PLACE.	2A
STANMORE LANE	NORTH	BETWEEN A POINT 10.8 METRES WEST OF ITS JUNCTION WITH WALTON PLACE AND A POINT 35.0 METRES EAST OF ITS JUNCTION WITH CROMWELL ROAD.	2A
STANMORE LANE	NORTH	BETWEEN A POINT 9.5 METRES WEST OF ITS JUNCTION WITH CROMWELL ROAD AND A POINT 21.0 METRES WEST OF THAT JUNCTION.	2A
STANMORE LANE	NORTH	BETWEEN A POINT 38.5 METRES WEST OF ITS JUNCTION WITH CROMWELL ROAD AND A POINT 10.0 METRES EAST OF ITS JUNCTION WITH EVERSLEY PLACE.	2A
STANMORE LANE	NORTH	BETWEEN A POINT 4.5 METRES EAST OF ITS JUNCTION WITH EVERSELEY PLACE AND A POINT 50.7 METRES WEST OF THAT JUNCTION.	2A
STANMORE LANE	NORTH	BETWEEN A POINT 63.9 METRES WEST OF ITS JUNCTION WITH EVERSELY PLACE AND A POINT 6.0 METRES EAST OF ITS JUNCTION WITH MILD MAY STREET.	2A
STANMORE LANE	SOUTH	BETWEEN A POINT 419.8 METRES EAST OF ITS JUNCTION WITH WAVELL WAY AND A POINT 435.8 METRES EAST OF THAT JUNCTION.	2A
STANMORE LANE	SOUTH	BETWEEN A POINT 457.5 METRES EAST OF ITS JUNCTION WITH WAVELL WAY AND A POINT 533.0 METRES WEST OF ITS JUNCTION WITH KINGS AVENUE.	2A
WALTON PLACE	BOTH	BETWEEN A POINT 5.2 METRES NORTH OF ITS JUNCTION WITH STANMORE LANE AND A POINT 37.8 METRES NORTH OF THAT JUNCTION.	2A

Schedule 8

NEW SCHEDULE SCHEDULE 1 PART 2A

Echelon Parking 2 Hour Limited Waiting With Permit Holders Exemption 8:00am to 6:00pm Monday to Saturday

<u>Road Name</u>	<u>Side</u>	<u>Description</u>	<u>Zone</u>
PAULET PLACE – SPINE	EAST	BETWEEN A POINT 56.0 METRES SOUTH OF ITS JUNCTION WITH STUART CRESCENT AND A POINT 63.9 METRES SOUTH OF THAT JUNCTION	2A

Given this day of 2015

THE COMMON SEAL OF WINCHESTER)
CITY COUNCIL was hereunto affixed)
in the presence of :-)