



## **PORTFOLIO HOLDER DECISION NOTICE**

### **INDIVIDUAL DECISION BY THE PORTFOLIO HOLDER FOR ENVIRONMENT**

### **TOPIC – TRAFFIC REGULATION ORDER – CROMWELL ROAD (BUNGALOWS) WINCHESTER**

### **PROCEDURAL INFORMATION**

The Access to Information Procedure Rules – Part 4, Section 22 of the Council's Constitution provides for a decision to be made by an individual member of Cabinet.

In accordance with the Procedure Rules, the Legal Services Manager, the Chief Executive and the Strategic Director: Resources are consulted together with Chairman and Vice Chairman of The Overview and Scrutiny Committee and any other relevant overview and scrutiny committee. In addition, all Members are notified.

If five or more Members from those informed so request, the Leader may require the matter to be referred to Cabinet for determination.

### **Contact Officers:**

**Case Officer: Neville Crisp – Traffic Engineer. Tel: 01962 848484. Email: ncrisp@winchester.gov.uk.**

**Democratic Services Officer:** Nancy Graham – Senior Democratic Services Officer. Tel: 01962 848235. Email: ngraham@winchester.gov.uk.

### **SUMMARY**

- Due to non-residents parking in the bays constructed primarily for the residents of the bungalows in Cromwell Road, Winchester WCC Housing and the local Councillor requested that the 2 hour limited waiting element of the parking restrictions be removed to help control parking and ensure that the bays are used only by resident permit holders.
- It is therefore being proposed to revise the existing '2 hours limited waiting with permit holders exemption 8am to 6pm Monday to Saturday' restrictions to 'Permit holders only 8am to 6pm Monday to Saturday'.
- The proposed changes were formally advertised on 22<sup>nd</sup> November 2017. Notices were posted on street in the immediate vicinity of the proposed changes, published in the Mid Hants Observer, placed on the Council's website and held on deposit in the city Office reception. In addition to this letters were sent to all residents of the bungalows notifying them that the

proposal was being advertised together with information of how to view the full details. No responses were received to the formal consultation.

- The proposal is in keeping with the Corporate Priorities in its attempt to improve traffic management, road safety and the environment.
- The cost of implementing the proposal is funded through the Traffic Management Agency Agreement with Hampshire County Council. There will be no additional enforcement resource implications.
- Copy of the plan showing the location and extent of the proposal as advertised is attached (Appendix 1).
- Copy of the schedule and statement of reasons as advertised is attached (Appendix 2).

### **DECISION**

- That restrictions be introduced as detailed in the schedule attached (Appendix 2).
- That the Legal Services Manager be authorised to make the necessary order.

### **REASON FOR THE DECISION AND OTHER ALTERNATIVE OPTIONS CONSIDERED AND REJECTED**

See Summary.

### **RESOURCE IMPLICATIONS:**

- The cost of advertising and implementing the traffic regulation order is covered by the Traffic Management Agency Agreement with Hampshire County Council.
- There will be no increase in enforcement resources or costs.

### **CONSULTATION UNDERTAKEN ON THE DECISION**

- Requests for consent to proceed to formal advertisement were sent to all local Ward Members, County Councillor, Police and Parking Office Manager and duly confirmed.
- Proposal notices were posted on street in the immediate vicinity of the proposed changes, published in the Mid Hants Observer, placed on the Council's website and held on deposit in the City Office reception. In addition

to this residents of the bungalows were written to directly to notify them of the proposal.

**FURTHER ALTERNATIVE OPTIONS CONSIDERED AND REJECTED FOLLOWING PUBLICATION OF THE DRAFT PORTFOLIO HOLDER DECISION NOTICE**

N/A

**DECLARATION OF INTERESTS BY THE DECISION MAKER OR A MEMBER OR OFFICER CONSULTED**

N/A

**DISPENSATION GRANTED BY THE STANDARDS COMMITTEE**

N/A

Approved by: (signature)

Date of Decision: 14.02.18

**Councillor Warwick – Portfolio Holder for Environment**

**APPENDICES:**

Appendix 1 – Copy of plan showing the location and extent of the proposed restrictions as advertised.

Appendix 2 – Copy of schedule and statement of reasons for the proposed restrictions as advertised.

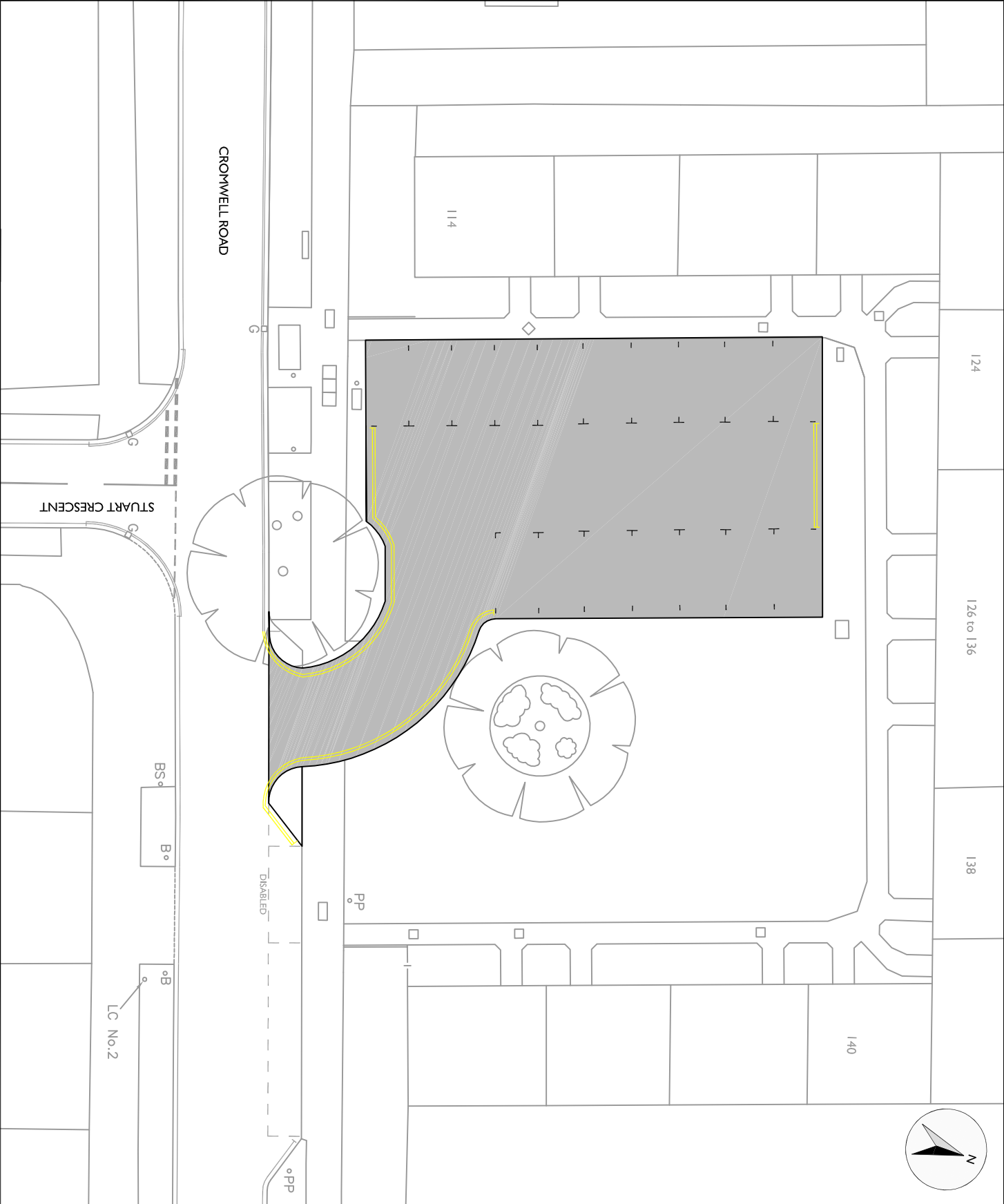

© Crown copyright and database rights 2012  
Winchester City Council license 100019531

**REPLACE 2 HOURS LIMITED  
WAITING WITH PERMIT  
HOLDERS EXEMPTION  
RESTRICTIONS WITH PERMIT  
HOLDERS ONLY RESTRICTIONS.**

Rev	Description	Date	Drawn



**Winchester**  
City Council

**OPERATIONS GROUP  
ACCESS & INFRASTRUCTURE**

City Office  
Colbrook Street  
Winchester  
SO23 9JY



Project: **TRAFFIC MANAGEMENT  
TRAFFIC REGULATION ORDER  
PROPOSAL**

Title: **REVISED WAITING RESTRICTIONS  
AIRLIE CORNER, STANNORE  
WINCHESTER**

Scale: 1:200 @ A3	Date: 12/07/2017
Drawn: MCS/ive	Checked:
DRG. No. 810402/394A/001	Status:

## PHD782 Appendix 2

### **PROPOSED VARIATION TO**

HAMPSHIRE COUNTY COUNCIL

ROAD TRAFFIC REGULATION ACT 1984

THE HAMPSHIRE (VARIOUS ROADS, WINCHESTER)  
(PARKING PLACES AND RESTRICTION OF WAITING)  
(CONTROLLED ZONE) (NO. 2) ORDER 2012 (VARIATION NO. 5) ORDER 2014

### **STATEMENT OF REASONS FOR REVISION**

On traffic management grounds to maximise parking provision.

### **ITEMS TO BE DELETED**

Schedule 1 Part 5  
Echelon Parking 2 Hours Limited Waiting with Permit Holders Exemption  
8.00 am to 6.00 pm Monday to Saturday

<u>Road Name</u>	<u>Side</u>	<u>Description</u>	<u>Zone</u>
CROMWELL ROAD	OFF-ROAD PARKING AREA 114-143 CROMWELL ROAD	AS DRAWING NO. 810402/322/001. SEE ANNEXE A TO ORDER	2A

Schedule 2  
No Waiting At Any Time

<u>Road Name</u>	<u>Side</u>	<u>Description</u>	<u>Zone</u>
CROMWELL ROAD	OFF-ROAD PARKING AREA 114-143 CROMWELL ROAD	AS DRAWING NO. 810402/322/001. SEE ANNEXE A TO ORDER	2A

**NEW ITEMS**

Schedule 1 Part **NEW**  
Echelon Parking Permit Holders Only  
8.00 am to 6.00 pm Monday to Saturday

<u>Road Name</u>	<u>Side</u>	<u>Description</u>	<u>Zone</u>
CROMWELL ROAD	OFF-ROAD PARKING AREA 114-143 CROMWELL ROAD	AS DRAWING NO. 810402/394A/001. SEE ANNEXE A TO ORDER	2A

Schedule 2  
No Waiting At Any Time

<u>Road Name</u>	<u>Side</u>	<u>Description</u>	<u>Zone</u>
CROMWELL ROAD	OFF-ROAD PARKING AREA 114-143 CROMWELL ROAD	AS DRAWING NO. 810402/394A/001. SEE ANNEXE A TO ORDER	2A