

# NEW ZEBRA CROSSING

Notice is hereby given of Hampshire County Council's intention to install a new Zebra crossing on Stoney Lane, Winchester, at the position shown on the plan below.

Construction of the crossing will not commence for a minimum of three months from the date of the notice.

Any person wishing to make a representation concerning this matter should do so in writing, to the Environment Department, Hampshire County Council, The Castle, Winchester, Hampshire, SO23 8UD within twenty eight days of the notice.

Date: 23rd March 2011

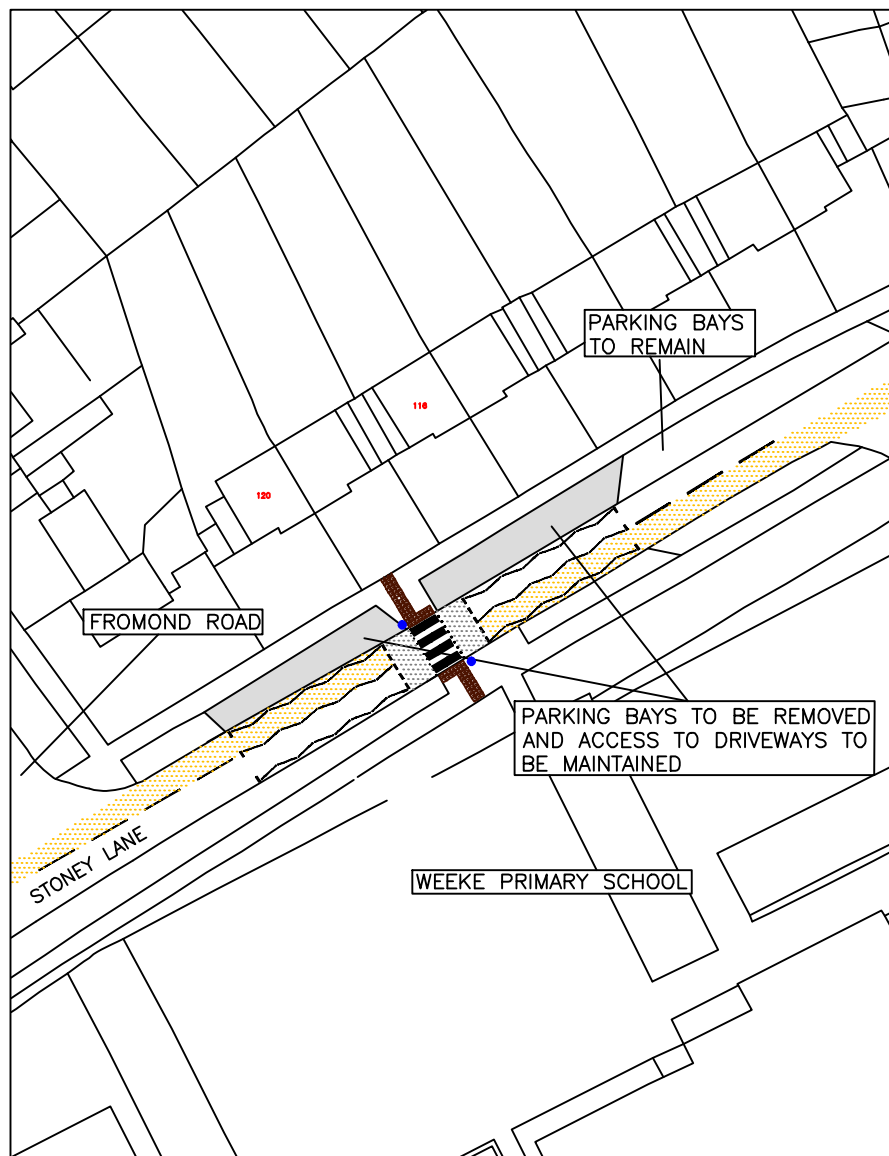

## KEY

- Belisha Beacon Pole
- ▨ Tactile Paving For Crossing
- Anti-Skid Road Surface
- Anti-Skid Road Surface

NOT TO SCALE

"REPRODUCED FROM THE ORDNANCE SURVEY MAPPING WITH THE PERMISSION OF THE CONTROLLER OF HER MAJESTY'S STATIONERY OFFICE © CROWN COPYRIGHT UNAUTHORISED REPRODUCTION INFRINGES CROWN COPYRIGHT AND MAY LEAD TO PROSECUTION OR CIVIL PROCEEDINGS".  
"HAMPSHIRE COUNTY COUNCIL, 100019180".

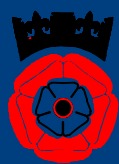

Hampshire  
County Council