



**Winchester**  
City Council

**TOWN AND COUNTRY PLANNING (GENERAL PERMITTED DEVELOPMENT)  
(ENGLAND) ORDER 2015**

**NOTICE PURSUANT TO SCHEDULE 3 PARAGRAPH 1(11)**

**CONFIRMATION OF ARTICLE 4 (1) DIRECTION (NON IMMEDIATE)**

On 13 December 2021 WINCHESTER CITY COUNCIL made a Direction under Article 4(1) of the Town and Country Planning (General Permitted Development) (England) Order 2015 in relation to land at Chalk Ridge, Winchester, Hampshire. The Council invited representations on the Direction between 15 December 2021 and 12 January 2022. No representations were received.

The Direction was confirmed by the Council on 7 November 2022 and will come into force on **19 December 2022**.

The Direction relates to Development consisting of a change of use of a building from a use falling within Class C3 (dwellinghouses) of the Schedule to the Town and Country Planning (Use Classes) Order 1987 to a use falling within Class C4 (houses in multiple occupation) of that Schedule, being development comprised within Class L (b) of Part 3 of Schedule 2 to the Town and Country Planning (General Permitted Development) (England) Order 2015 and not being development comprised within any other class.

Planning permission will therefore be required for a change of use from Class C3 to Class C4 once the Article 4 Direction is in force.

A copy of the Direction and of the map defining the area of land covered by it may be seen at the offices of the Council at City Offices, Colebrook Street, Winchester, Hampshire SO23 9LJ during normal office hours and on the Council's website at <https://www.winchester.gov.uk/public-notices-library>

Dated: 9 November 2022

Signed: Neil McArthur, Service Lead-Legal, Winchester City Council.



**THE TOWN AND COUNTRY PLANNING  
(GENERAL PERMITTED DEVELOPMENT ) (ENGLAND) ORDER 2015  
DIRECTION WITHOUT IMMEDIATE EFFECT MADE UNDER ARTICLE 4(1)**

WHEREAS **Winchester City Council** being the appropriate local planning authority within the meaning of Article 4(5) of the Town and Country Planning (General Permitted Development)(England) Order 2015 are satisfied that it is expedient that development of the description set out in the Schedule below should not be carried out on the land shown edged in bold black on the attached plan (being land in the area known as Chalk Ridge, Winchester, Hampshire) unless planning permission is granted on an application made under Part III of the Town and Country Planning Act 1990 as amended.

NOW THEREFORE the said Council in pursuance of the power conferred on them by Article 4(1) of the Town and Country Planning (General Permitted Development) (England) Order 2015 hereby direct that the permission granted by Article 3 of the said Order shall not apply to development on the said land of the description set out in the Schedule below:

This Article 4 Direction will come into force on **19 December 2022.**

**SCHEDULE**

Development consisting of a change of use of a building from a use falling within Class C3 (dwellinghouses) of the Schedule to the Town and Country Planning (Use Classes) Order 1987 to a use falling within Class C4 (houses in multiple occupation) of that Schedule, being development comprised within Class L(b) of Part 3 of Schedule 2 to the Town and Country Planning (General Permitted Development) (England) Order 2015 and not being development comprised within any other class.

Dated: 13 December 2021

NO. IN SEAL  
REGISTER:  
11486

The Common Seal of Winchester City Council  
was affixed to this Direction in the presence of:

*John Fairhall*

Authorised signatory

*John Fairhall*



Confirmed under the Common Seal of Winchester City Council

affixed this *7<sup>th</sup>* day of *November* 2022 in the presence of:

*NMCA*

Authorised signatory

*NEIL MCARTHUR  
SERVICE LEADS - CE2AC*

NO. IN SEAL  
REGISTER:  
11998



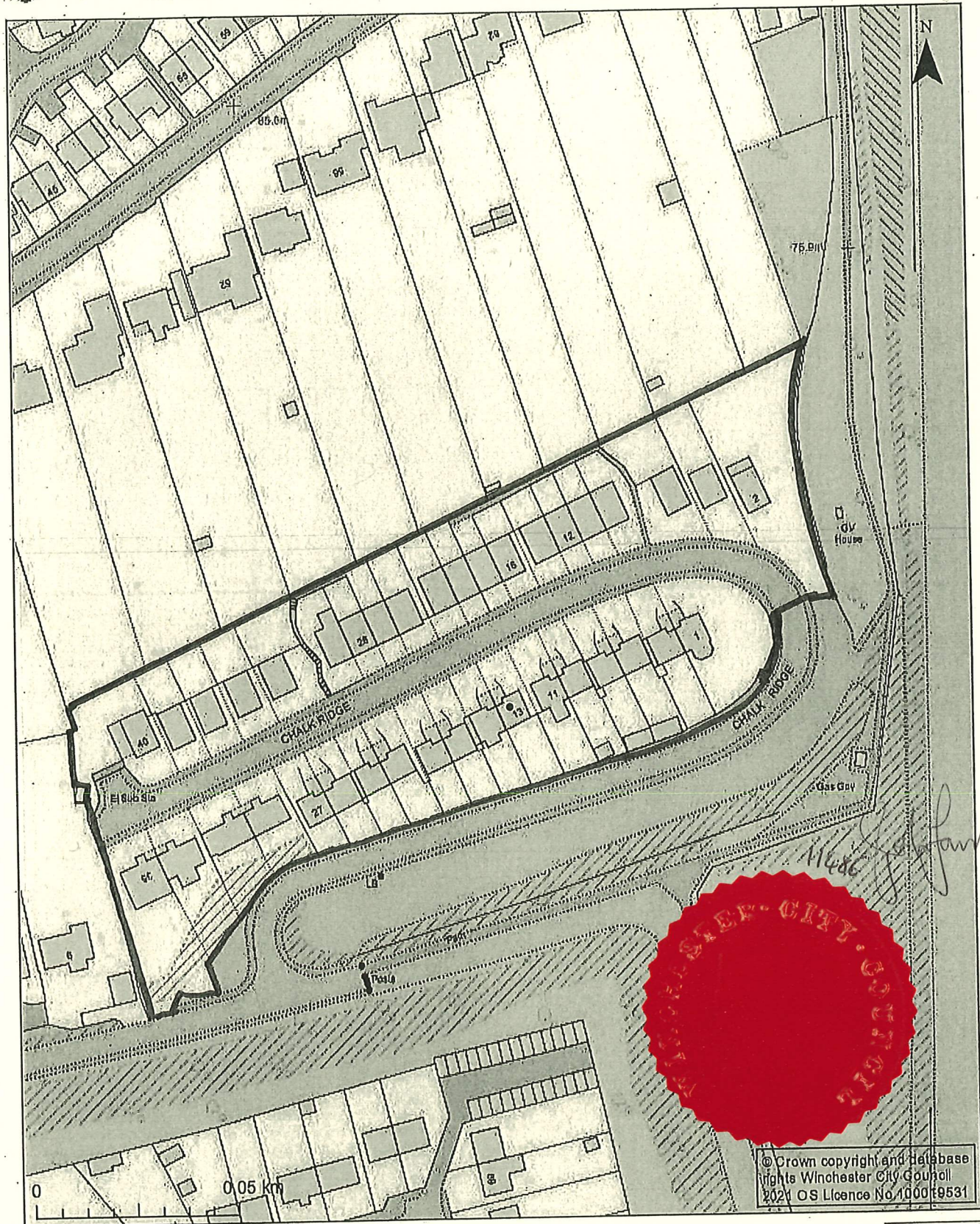

Date: 23/09/2021

Scale: 1:1,250

Author:

Chalk Ridge, Winchester

**Legend**